

FOR SERVICE TECHNICIAN ONLY—DO NOT REMOVE OR DESTROY

"L" WASHER

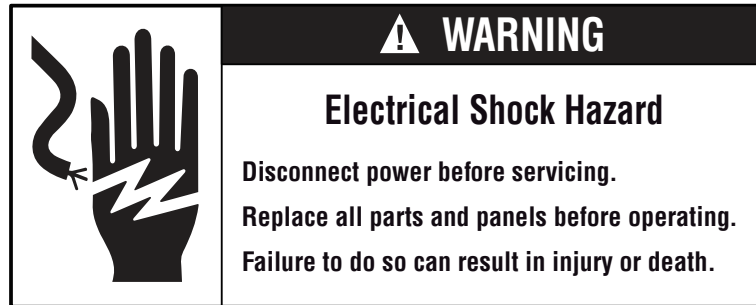

IMPORTANT Electric Discharge (ESD) Sensitive Electronics

ESD problems are present everywhere. ESD may damage or weaken the electronic control assembly. The new control assembly may appear to work well after repair is finished, but failure may occur at a later date due to ESD stress.

- Use an anti-static wrist strap. Connect wrist strap to ground connection point or unpainted metal in the appliance.

–OR–

Touch your finger repeatedly to ground connection point or unpainted metal in the appliance.

- Before removing the part from its package, touch the anti-static bag to a green ground connection point or unpainted metal in the appliance.
- Avoid touching electronic parts or terminal contact; handle electronic control assembly by edges only.
- When repackaging failed electronic control assembly in anti-static bag, observe above-mentioned precautions.

Programming the Control Board

- The replacement control board will always enter into test mode t01 on initial power-up.
- If replacing the control board, the washer will not function until the replacement control board has been programmed.

To program the replacement control board:

1. Reconnect power to the washer. (After press Power button, the display will now show "---", which means no model has been selected.)
2. Rotate the cycle knob until the correct model number is displayed:
Display "01" = MFD140-G1224/E0154ED-SA05
Display "02" = MFD140-G1224/E0154ED
3. Press and hold the Start key for 5 seconds (or until a second beep is sounded).
4. Press the Signal key to reset the control.

Note: If an error is made in programming the control, enter test mode and select t01. Then repeat steps 2 through 4.

DIAGNOSTIC GUIDE

Before testing washer operation, check the following:

- Is the power cord firmly plugged into a live circuit?
- Has a household fuse blown or circuit breaker tripped? Time delay fuse?
- Are both hot and cold water faucets open and water supply hoses unobstructed?

Before opening the unit make sure the washer is unplugged from power outlet.

- Check all connections before replacing components. Look for broken or loose wires, failed terminals, or wires not pressed into connections far enough.
- The most common cause for control failure is corrosion on connectors. Therefore, disconnecting and reconnecting wires will be necessary throughout test procedures.
- Connectors: Look at top of connector. Check for broken or loose wires. Check for wires not pressed into connector far enough to engage metal bars.
- Resistance check must be made with power cord unplugged from outlet, and with wiring harness or connectors disconnected.

FOR SERVICE TECHNICIAN ONLY—DO NOT REMOVE OR DESTROY

WIRE DRAWING

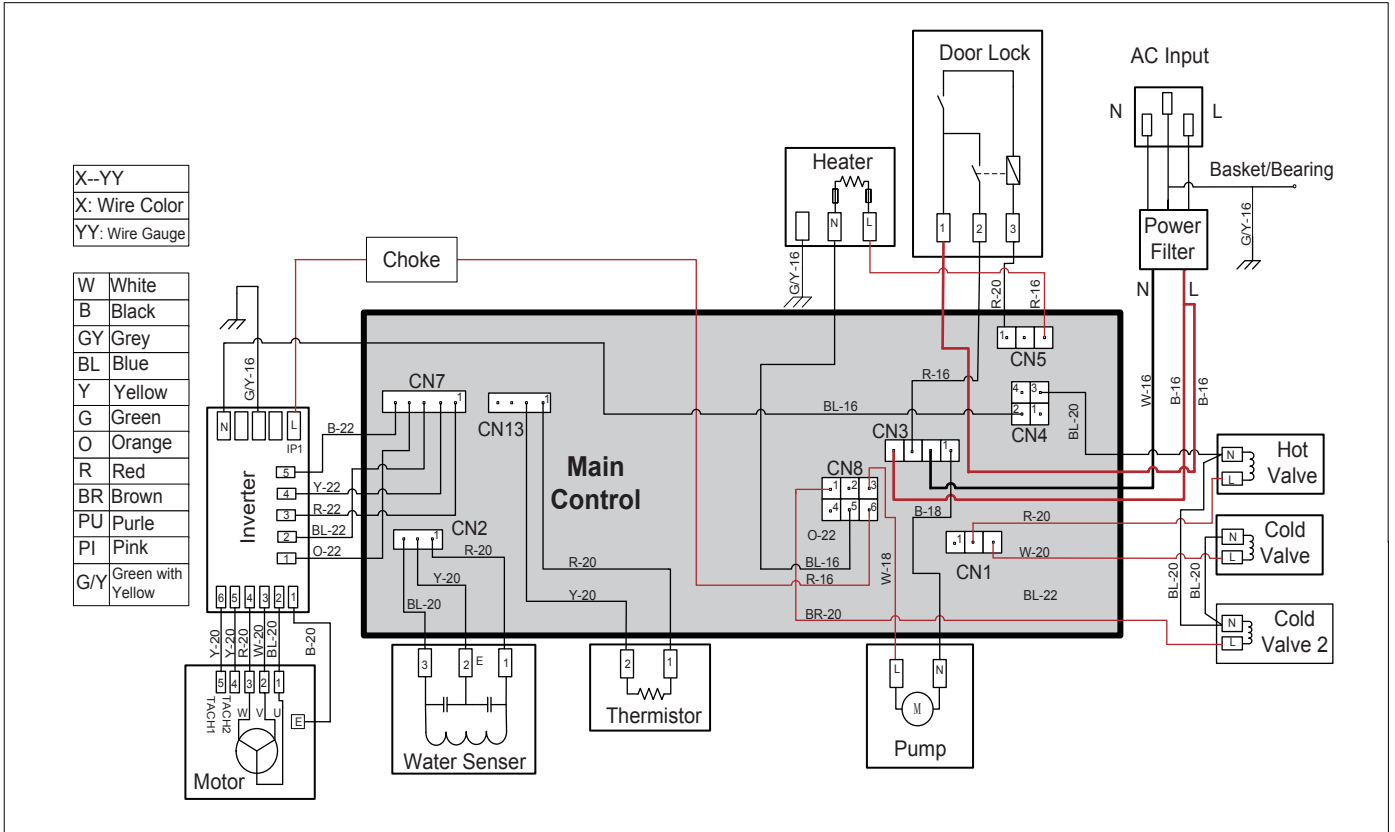

FOR SERVICE TECHNICIAN ONLY—DO NOT REMOVE OR DESTROY

SYSTEM DRAWING

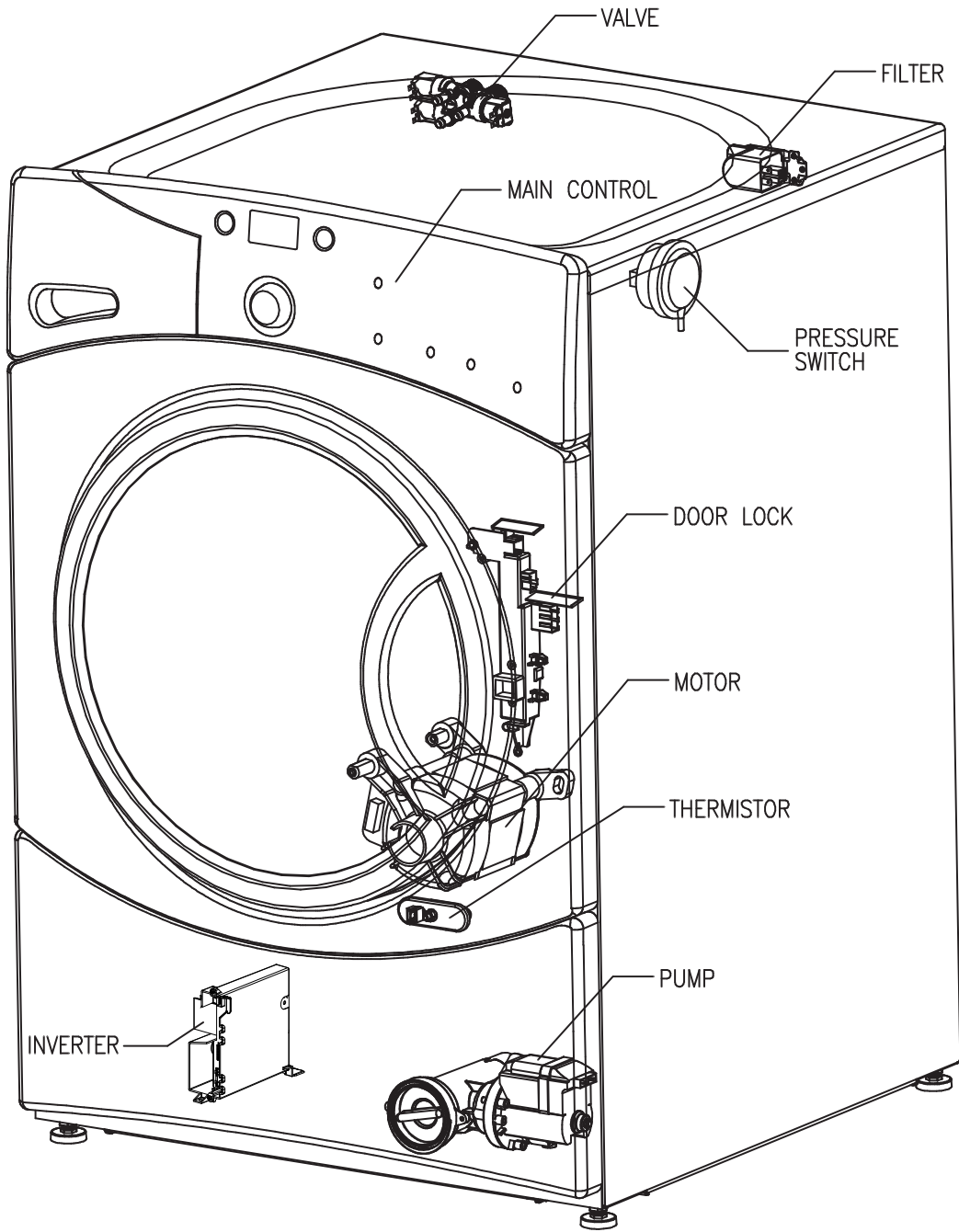

FOR SERVICE TECHNICIAN ONLY—DO NOT REMOVE OR DESTROY

CONTROL BOARD CONNECTOR LOCATIONS

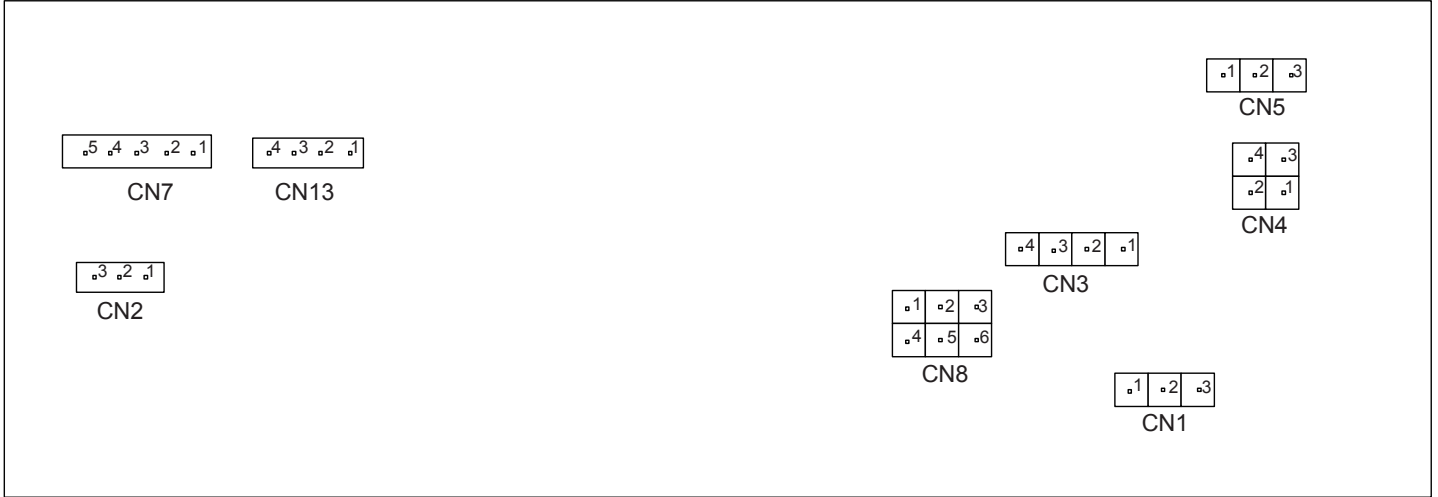

SERVICE MODE

To Enter: Press Power button then alternately press **Temp - E wash**.

To Exit: Repeat press **Signal**.

TEST LIST

- "t01" Model ID**
Verifies (or sets on new board) the proper model id
- "t02" Error Codes**
Lists up to 10 control-detected problems
- "t03" Software ID**
Verifies using latest Project - UL code - Control - inverter software
- "t04" Exercise LCD/LEDs**
Verifies that all the displays and buttons work
- "t05" Pump Test**
Test drain-out pump
- "t06" Water Level Sensor Test**
Fills to all 3 levels, then pumps out water
- "t07" Thermistor/Heater Test**
Verifies that both the thermistor and heater work
- "t10" Tumble Test**
Verifies washer tumbles (i.e. **Wash** cycle)
- "t11" Spin Test**
Verifies washer spins
- "t12" Dispenser Test**
Verifies dispenser fill works-for all three fill models
- "t13" EOL Test**
Performs end-of-line test sequence

FOR SERVICE TECHNICIAN ONLY—DO NOT REMOVE OR DESTROY

DETAILS FUNCTION

	Requirement		Sequence
t01	none	Start	if new board (to set model id, rotate knob until desired id is displayed, press and hold Start key to program this model)
		Start	Returns to "t01"
t02	none	Start	Displays most recent error code (E00=none)
		Rotate the knob	Displays previous error code (up to previous 10)
		Hold start	Clear all error codes (and then displays E00)
		Start	Returns to "t02"
t03	none	Start	Alternate "Pro" and Project version
		Start	Alternate "UL" and UL software version
		Start	Alternate "cod" and Control Software version
		Start	Alternate "Inv" and Inverter Software version
		Start	Returns to "t03"
t04	none	Start	Loops on lighting LED's, LCD, and cycle ids
		Any button	Beeps when depressed
		Start	Returns to "t04"
t05	none	Start	Displays "P" and pump for 60 seconds
		Signal	Returns to "t05"
t06	none	Start	The control will display "water level frequency". The water level frequency continues updating on the 7-segment display until reaches wash 1 level.
		Start	Fill, until reaches wash 2 level
		Start	Fill, until reaches overflow level
		Signal	Returns to "t06"
t07	water pressure sensor must work	Start	Displays temperature in °F, turns on cold water and fills the tub until the wash 1 level is reached. Then turns on heater for a maximum of 5 minutes.
		Signal	Pumps out water and returns to "t07"
t10	none	Start	Displays "tt" and tumbles tub alternating the direction every 5 seconds
		Signal	Stops tumbling and returns to "t10"
t11	none	Start	Spins to 400 RPM displaying increasing RPM
		Start	Spin to 1200RPM (display C00)
		Signal	Stops spinning and returns to "t11" until it stops
t12	none	Start	Start - Displays "ddt" and turns on HV to fill detergent compartment. Start - Displays "bdt" and turns on CV2 to fill bleach compartment Start - Displays "Fdt" and turns on CV1 and CV2 to fill softener compartment Start - Displays "Hct" and turns on CV1 and HV to fill detergent compartment
		Signal	Pumps out water and returns to "t12"
t13	none	Start	Starts EOL test sequence (NOT used in repair)
		Signal	Returns to "t13"

FOR SERVICE TECHNICIAN ONLY—DO NOT REMOVE OR DESTROY

TROUBLESHOOTING CHART

Code(s)	Description	Action
22, 23	Fill problems	<ul style="list-style-type: none"> • Ensure manual water valves are fully open. • Check if water strainers on solenoid valve assembly are clogged. • Check for obstructions inside inlet water hoses. • Ensure solenoid valves do not leak when the valves are de-energized and the washer is powered down. • Measure coil resistance for both valves; if outside range (1000–1250 ohms at room temp.), replace solenoid valve assembly. <p>IF ABOVE STEPS DO NOT CLEAR THE PROBLEM, OR FOR ERROR CODE 23:</p> <ul style="list-style-type: none"> • Replace solenoid valve assembly.
31	Drain problems	<ul style="list-style-type: none"> • Ensure pump strainer is clean and free of debris. • Check for obstruction inside the drain hose. • Check pump impeller blades and bearing; if evidence of blade damage or seized bearings are present, replace the pump. • Check electrical connections at the pump motor and harness. • Measure pump motor resistance; if outside range (9–14 ohms at room temp.) replace the pump.
42, 45, 46, 47, 48	Motor Drive operation above design limits	<ul style="list-style-type: none"> • Ensure all 4 shipping bolts have been properly removed. • Remove all foreign objects that may be lodged between inner and outer basket. • Look for signs of seized bearing(s) on basket and drum motor, replace components as necessary. • Inspect condition and mounting of door gasket, replace and re-mount as necessary. • Ensure inner basket (drum) can rotate freely. <p>IF ABOVE STEPS DO NOT CLEAR THE PROBLEM:</p> <ul style="list-style-type: none"> • Replace motor drive or drum motor.
4A, 4B, 4C, 50, 52, 54	Motor Drive internal problems	<ul style="list-style-type: none"> • Measure AC outlet voltage, ensure correct range (102V to 132V AC). • Check electrical connections at the drum motor, motor drive. • Check harness integrity between main control and motor drive. • Unplug the unit, wait 30 seconds, restart the unit. • If the fault persists and re-appears – replace the motor drive.
56	Main Control internal problems	<ul style="list-style-type: none"> • Replace the main control.
57, 58,	Main Control internal problems	<ul style="list-style-type: none"> • Unplug the unit, wait 30 seconds, re-start the unit. • If the fault persists and re-appears – replace the main control.
60, 61, 63, 64,	DOOR LOCK assembly problems	<ul style="list-style-type: none"> • Check integrity of wiring and connections between main control and DOOR LOCK mechanism. • Investigate DOOR LOCK mechanism, check door microswitch operation, lock and unlock solenoid continuity, contact integrity; replace DOOR LOCK mechanism if necessary. <p>IF ABOVE STEPS DO NOT CLEAR THE PROBLEM:</p> <ul style="list-style-type: none"> • Replace the main control.
65	Water Level Sensor problems	<ul style="list-style-type: none"> • Check integrity of wiring and connections between main control and Water Level Sensor. • Check integrity of Water Level Sensor, replace if necessary. <p>IF ABOVE STEPS DO NOT CLEAR THE PROBLEM:</p> <ul style="list-style-type: none"> • Replace the main control.
66, 67	Water Temperature Sensor problems	<ul style="list-style-type: none"> • Check integrity of wiring and connections between main control and Thermistor Assembly. • Using ohmmeter, measure Thermistor resistance; if outside expected range, replace Thermistor Assembly. <p>IF ABOVE STEPS DO NOT CLEAR THE PROBLEM:</p> <ul style="list-style-type: none"> • Replace the main control.
62	System Contact Failure	<ul style="list-style-type: none"> • Check integrity of wiring and connections, look for insulation breakdown and short circuit conditions on the harness, replace harness if necessary. • Check integrity and electrical connections of all loads (heater, pump, pressure switch, door lock, solenoid valves, dispenser motor), replace respective components if necessary. <p>IF ABOVE STEPS DO NOT CLEAR THE PROBLEM:</p> <ul style="list-style-type: none"> • Replace the main control.

FOR SERVICE TECHNICIAN ONLY—DO NOT REMOVE OR DESTROY

FOR SERVICE TECHNICIAN ONLY—DO NOT REMOVE OR DESTROY

MFD140-G1224/E0154ED

MFD140-G1224/E0154ED-SA05

062014