



La solution assistance

## ERROR CODE



La solution assistance



**Français**

Page de

2

à

3



**English**

Page de

4

à

5



**Español**

Page de

6

à

7



**Português**

Page de

8

à

9

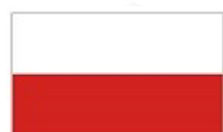

**Polski**

Page de

10

à

11



**Magyar**

Page de

12

à

13



**Română**

Page de

14

à

15



**Deutsch**

Page de

16

à

17

*La solution assistance*

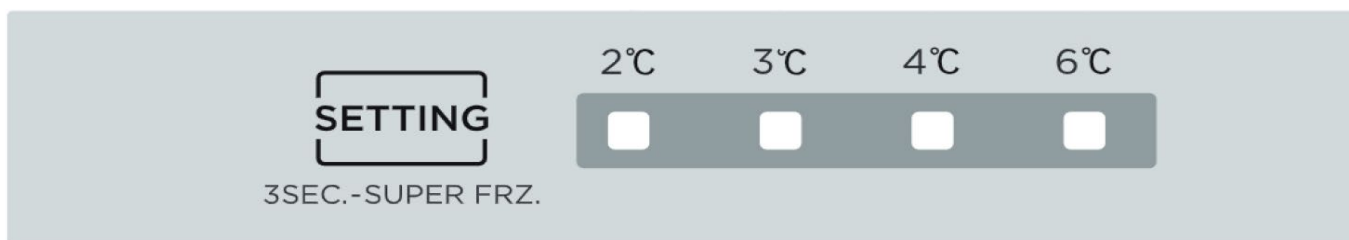

CODE ERREUR (Voyants)	DESCRIPTION	ORIGINES
2°C	Défaut sonde REFRIGERATEUR	Vérifier câblage, sonde, platine
3°C	Défaut sonde DÉGIVRAGE	Vérifier câblage, sonde, platine
6°C	Défaut sonde AMBIANT	Vérifier câblage, sonde, platine

Valeurs sonde					
T (°C)	R (KΩ)	T (°C)	R (KΩ)	T (°C)	R (KΩ)
-30	33.81	-5	8.392	6	4.818
-25	25.17	0	6.495	8	4.372
-22	21.18	1	6.175	10	3.972
-20	18.9	2	5.873	15	3.141
-18	16.9	3	5.587	20	2.501
-16	15.12	4	5.315	25	2.005
-10	10.92	5	5.06	30	1.617

**Remplacement sonde de température FMF112010070795** : Cette sonde est générique, vous pouvez être amené à couper les fils de la sonde défectueuse et à ressouder la nouvelle lors de son remplacement si le connecteur est différent.

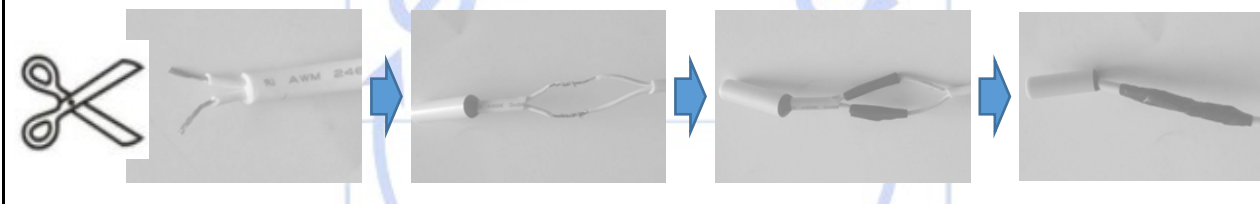

*La solution assistance*

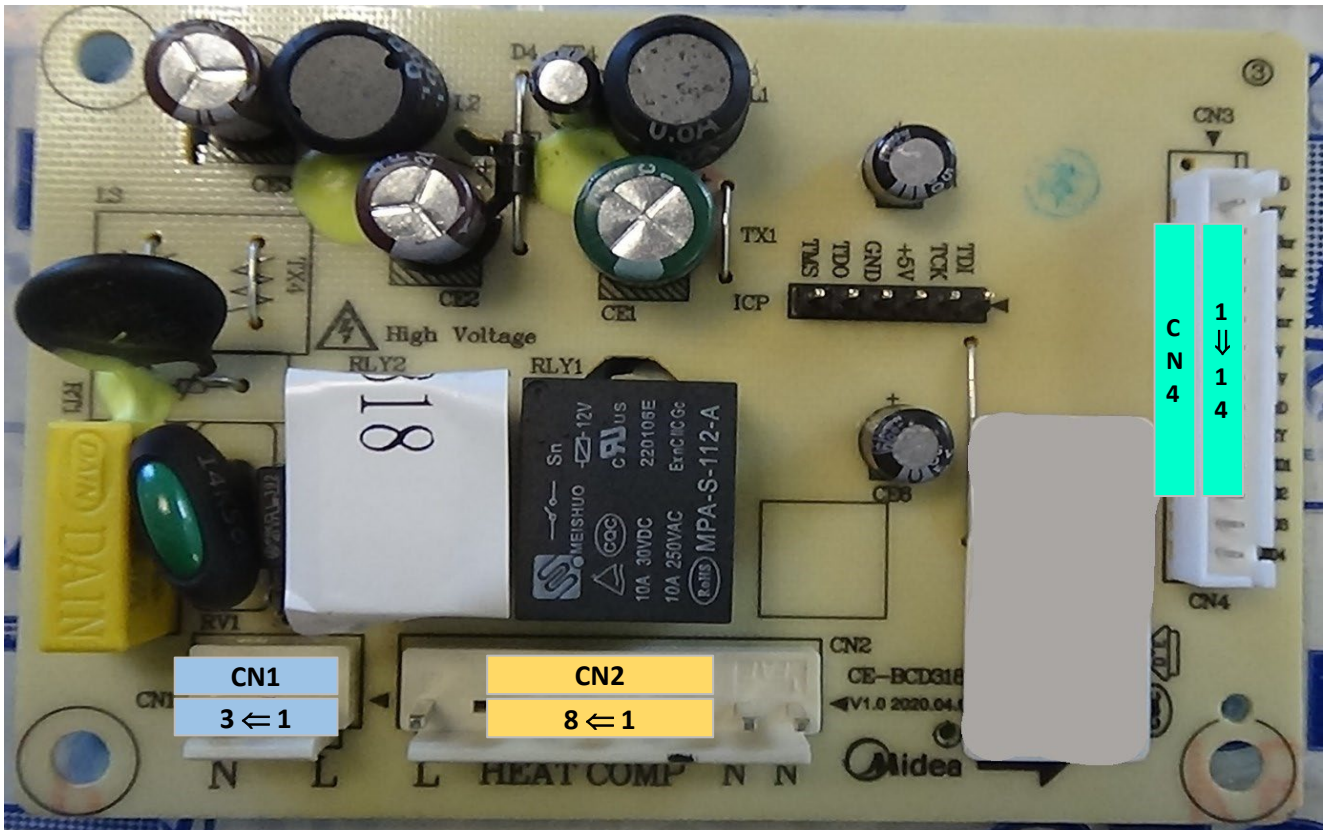

CN4	1	Gnd	-	CN1	3	N	Alimentation
	2	+5V	Sonde ambiant		2	-	
	3	A-Snr			1	L	
	4	FdSnr	Sonde dégivrage	CN2	8	L	L
	5	+5V			7	-	-
	6	R-Snr	Sonde réfrigérateur		6	Heat	Résistance dégivrage
	7	+5V			5	-	-
	8	+5V	-		4	Comp	Compresseur
	9	Gnd	-		3	-	-
	10	KEY	-		2	N	N
	11	LED1	-		1	N	N
	12	LED2	-				
	13	LED3	-				
	14	LED4	-				

La solution assistance

SETTING

2°C
3°C
4°C
6°C

3SEC.-SUPER FRZ.

ERROR CODE (LEDs)	DESCRIPTION	ORIGINS
2°C	REFRIGERATOR sensor fault	Check wiring, probe, board
3°C	DEFROST sensor fault	Check wiring, probe, board
6°C	AMBIENT sensor fault	Check wiring, probe, board

Probe values					
(°C)	R (KΩ)	(°C)	R (KΩ)	(°C)	R (KΩ)
-30	33.81	-5	8.392	6	4.818
-25	25.17	0	6.495	8	4.372
-22	21.18	1	6.175	10	3.972
-20	18.9	2	5.873	15	3.141
-18	16.9	3	5.587	20	2.501
-16	15.12	4	5.315	25	2.005
-10	10.92	5	5.06	30	1.617

**Temperature sensor replacement FMF112010070795** : This probe is generic, you may have to cut the wires of the defective probe and resolder the new one when replacing it if the connector is different.

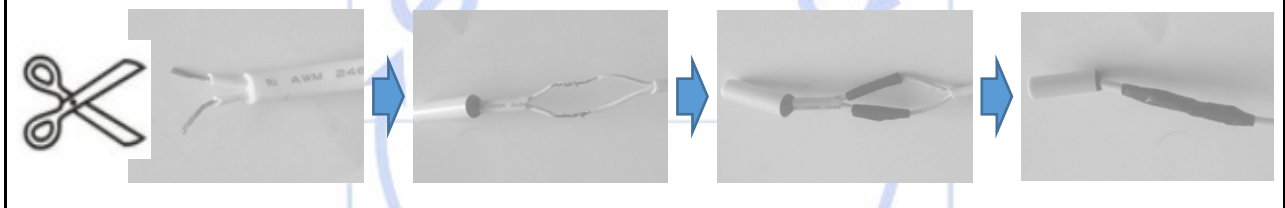

*La solution assistance*

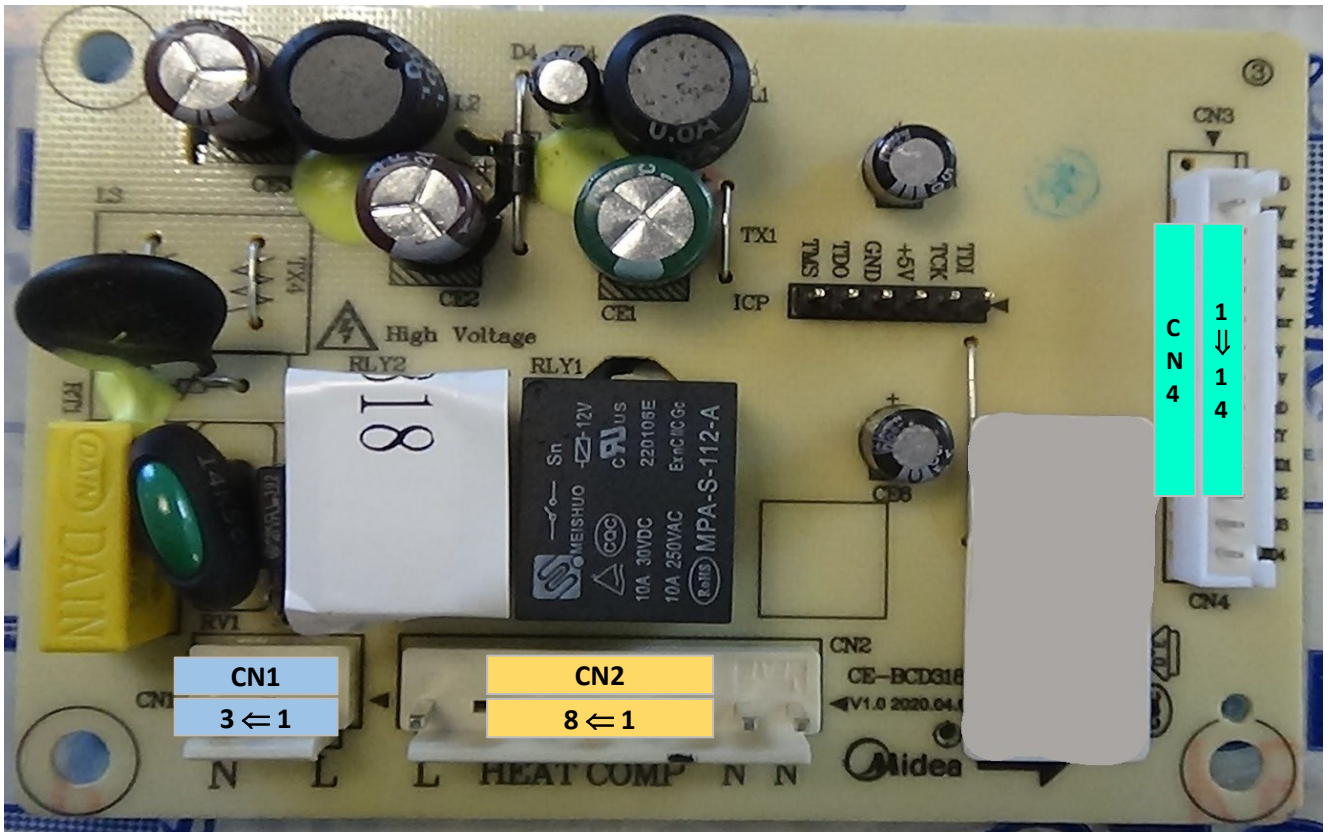

CN4	1	Gnd	-	CN1	3	N	Feed
	2	+5V	Ambient probe		2	-	
	3	A-Snr			1	L	
	4	FdSnr	Defrost probe	CN2	8	L	L
	5	+5V			7	-	-
	6	R-Snr	Fridge probe		6	Heat	Defrost resistance
	7	+5V			5	-	-
	8	+5V	-		4	Comp	Compressor
	9	Gnd	-		3	-	-
	10	KEY	-		2	N	NOT
	11	LED1	-		1	N	NOT
	12	LED2	-				
	13	LED3	-				
	14	LED4	-				

La solution assistance

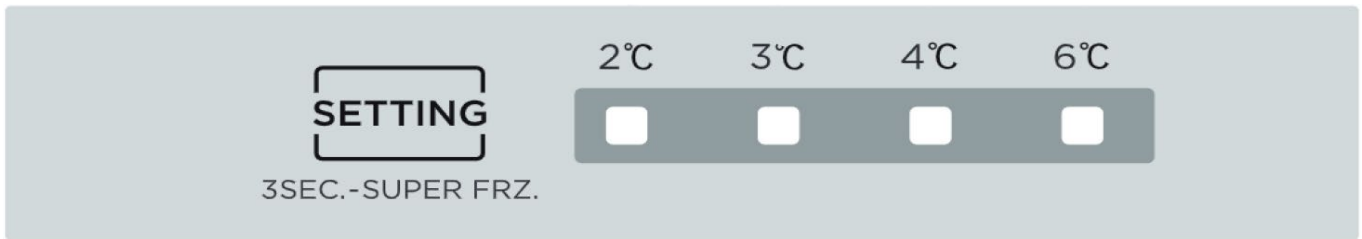

CÓDIGO DE ERROR (LED)	DESCRIPCIÓN	ORÍGENES
2°C	Avería sonda REFRIGERADOR	Comprobar cableado, sonda, placa
3°C	Avería sensor DESCONGELACIÓN	Comprobar cableado, sonda, placa
6°C	Fallo sensor AMBIENTE	Comprobar cableado, sonda, placa

Valores de la sonda					
temperatura	R (KΩ)	temperatura	R (KΩ)	temperatura	R (KΩ)
-30	33.81	-5	8.392	6	4.818
-25	25.17	0	6.495	8	4.372
-22	21.18	1	6.175	10	3.972
-20	18.9	2	5.873	15	3.141
-18	16.9	3	5.587	20	2.501
-16	15.12	4	5.315	25	2.005
-10	10.92	5	5.06	30	1.617

**Reemplazo del sensor de temperatura FMF112010070795** : Esta sonda es genérica, es posible que tenga que cortar los cables de la sonda defectuosa y volver a soldar la nueva al reemplazarla si el conector es diferente.

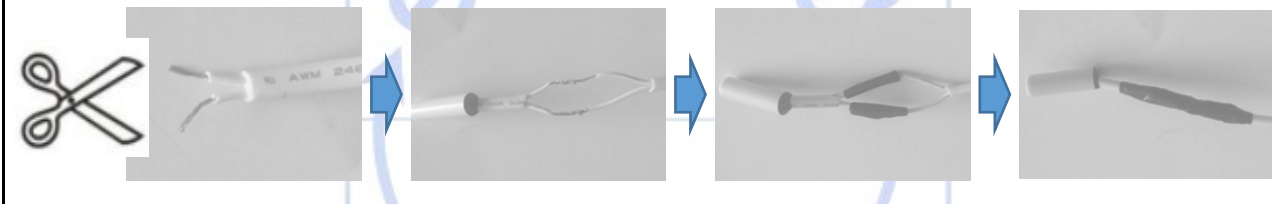

*La solution assistance*

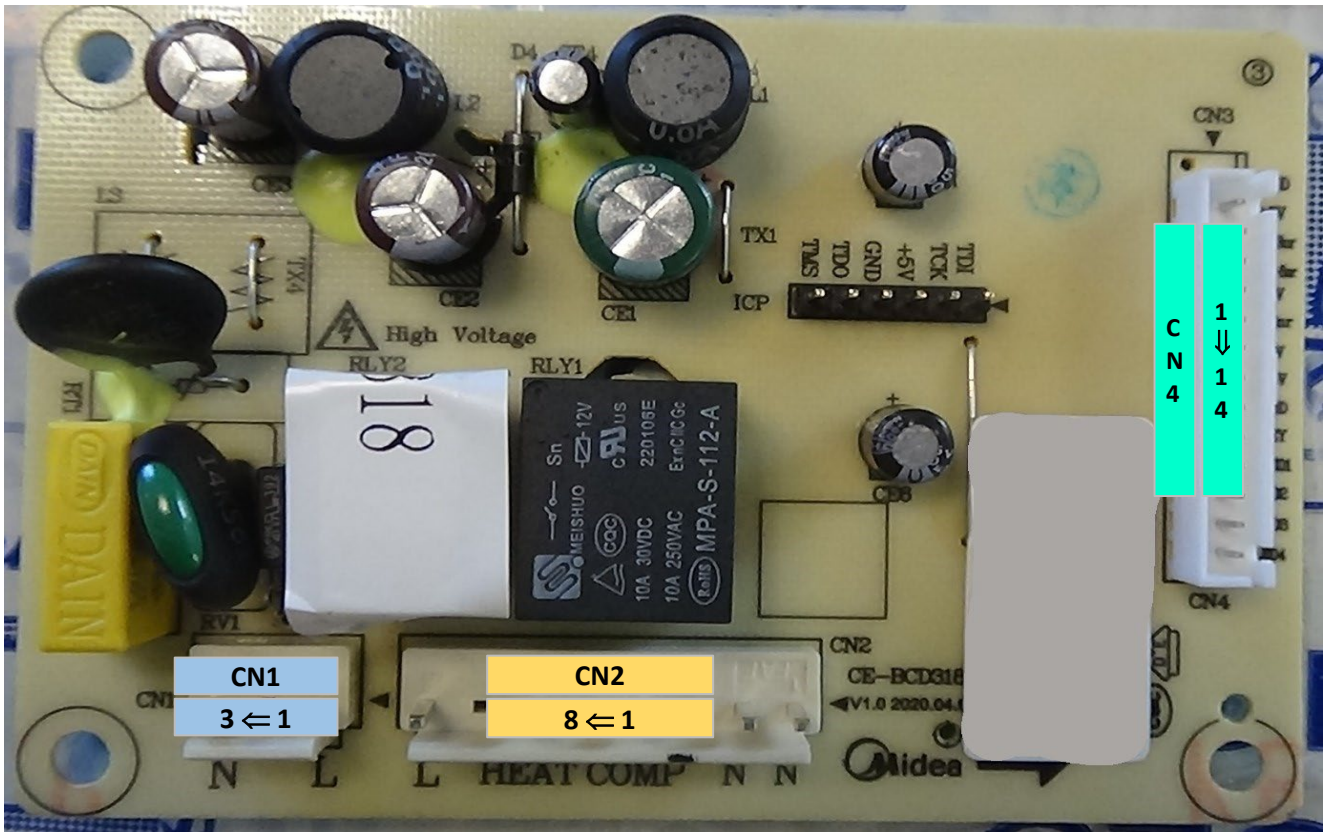

CN4	1	Gnd	-	CN1	3	N	Alimento
	2	+5V	Sonda ambiental		2	-	
	3	A-Snr			1	L	
	4	FdSnr	Sonda de desescarche	CN2	8	L	L
	5	+5V			7	-	-
	6	R-Snr	Sonda nevera		6	Heat	Resistencia al descongelamiento
	7	+5V			5	-	-
	8	+5V	-		4	Comp	Compresor
	9	Gnd	-		3	-	-
	10	KEY	-		2	N	NO
	11	LED1	-		1	N	NO
	12	LED2	-				
	13	LED3	-				
	14	LED4	-				

La solution assistance



# Lista de códigos de erro

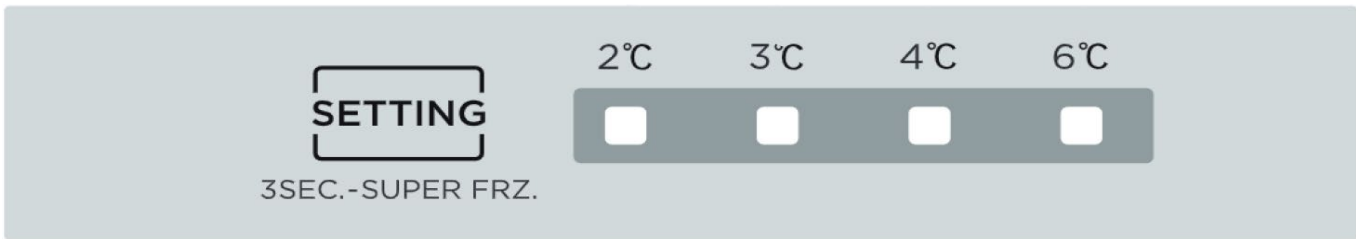

CÓDIGO DE ERRO (LEDs)	DESCRIÇÃO	ORIGENS
2°C	Falha no sensor do REFRIGERADOR	Verifique a fiação, sonda, placa
3°C	Falha no sensor de DESCONGELAÇÃO	Verifique a fiação, sonda, placa
6°C	Falha do sensor AMBIENTE	Verifique a fiação, sonda, placa

Valores da sonda					
(°C)	R (KX)	(°C)	R (KX)	(°C)	R (KX)
-30	33.81	-5	8.392	6	4.818
-25	25.17	0	6.495	8	4.372
-22	21.18	1	6.175	10	3.972
-20	18.9	2	5.873	15	3.141
-18	16.9	3	5.587	20	2.501
-16	15.12	4	5.315	25	2.005
-10	10.92	5	5.06	30	1.617

**Substituição do sensor de temperatura FMF112010070795** : Esta sonda é genérica, você pode ter que cortar os fios da sonda defeituosa e ressoldar a nova ao substituí-la se o conector for diferente.

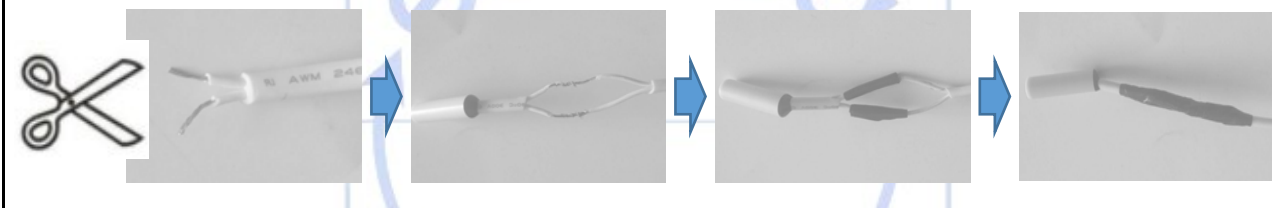

La solution assistance



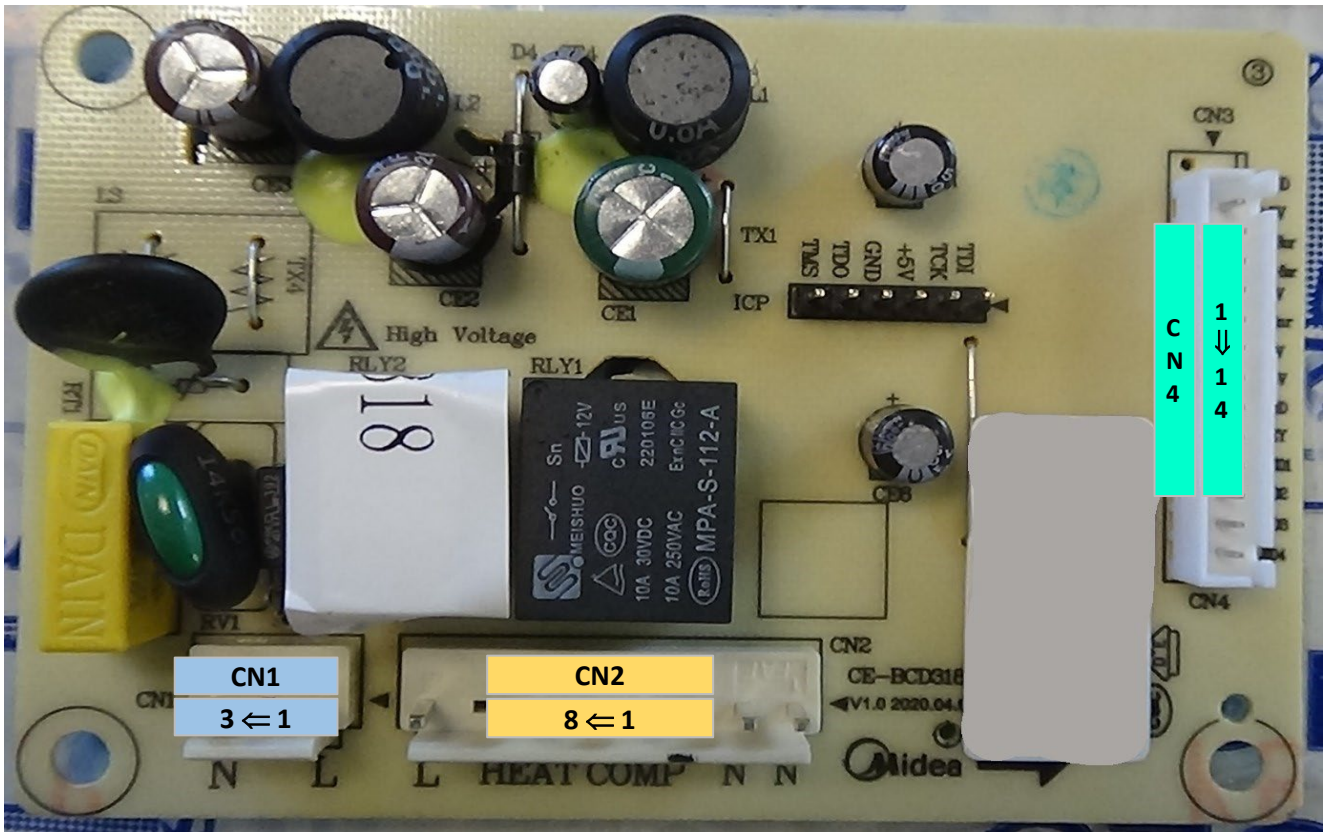

CN4	1	Gnd	-	CN1	3	N	Alimentação
	2	+5V	Sonda ambiente		2	-	
	3	A-Snr			1	L	
	4	FdSnr	Sonda de descongelamento	CN2	8	L	eu
	5	+5V			7	-	-
	6	R-Snr	Sonda de geladeira		6	Heat	Resistência ao degelo
	7	+5V			5	-	-
	8	+5V	-		4	Comp	Compressor
	9	Gnd	-		3	-	-
	10	KEY	-		2	N	NÃO
	11	LED1	-		1	N	NÃO
	12	LED2	-				
	13	LED3	-				
	14	LED4	-				

La solution assistance

SETTING

3SEC.-SUPER FRZ.

2°C

3°C

4°C

6°C

KOD BŁĘDU (diody LED)	OPIS	POCHODZENIE
2°C	Usterka czujnika CHŁODZIARKI	Sprawdź okablowanie, sondę, płytkę
3°C	Usterka czujnika ODSZRANIANIA	Sprawdź okablowanie, sondę, płytkę
6°C	Usterka czujnika OTOCZENIA	Sprawdź okablowanie, sondę, płytkę

### Wartości sondy

(°C)	R (KΩ)	(°C)	R (KΩ)	(°C)	R (KΩ)
-30	33.81	-5	8.392	6	4.818
-25	25.17	0	6.495	8	4.372
-22	21.18	1	6.175	10	3.972
-20	18.9	2	5.873	15	3.141
-18	16.9	3	5.587	20	2.501
-16	15.12	4	5.315	25	2.005
-10	10.92	5	5.06	30	1.617

Wymiana czujnika temperatury FMF112010070795 : Ta sonda jest ogólna, może być konieczne przecięcie przewodów uszkodzonej sondy i odsprzedanie nowej podczas wymiany, jeśli złącze jest inne.

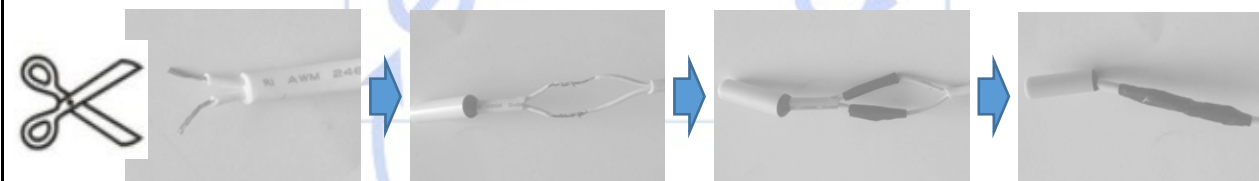

La solution assistance

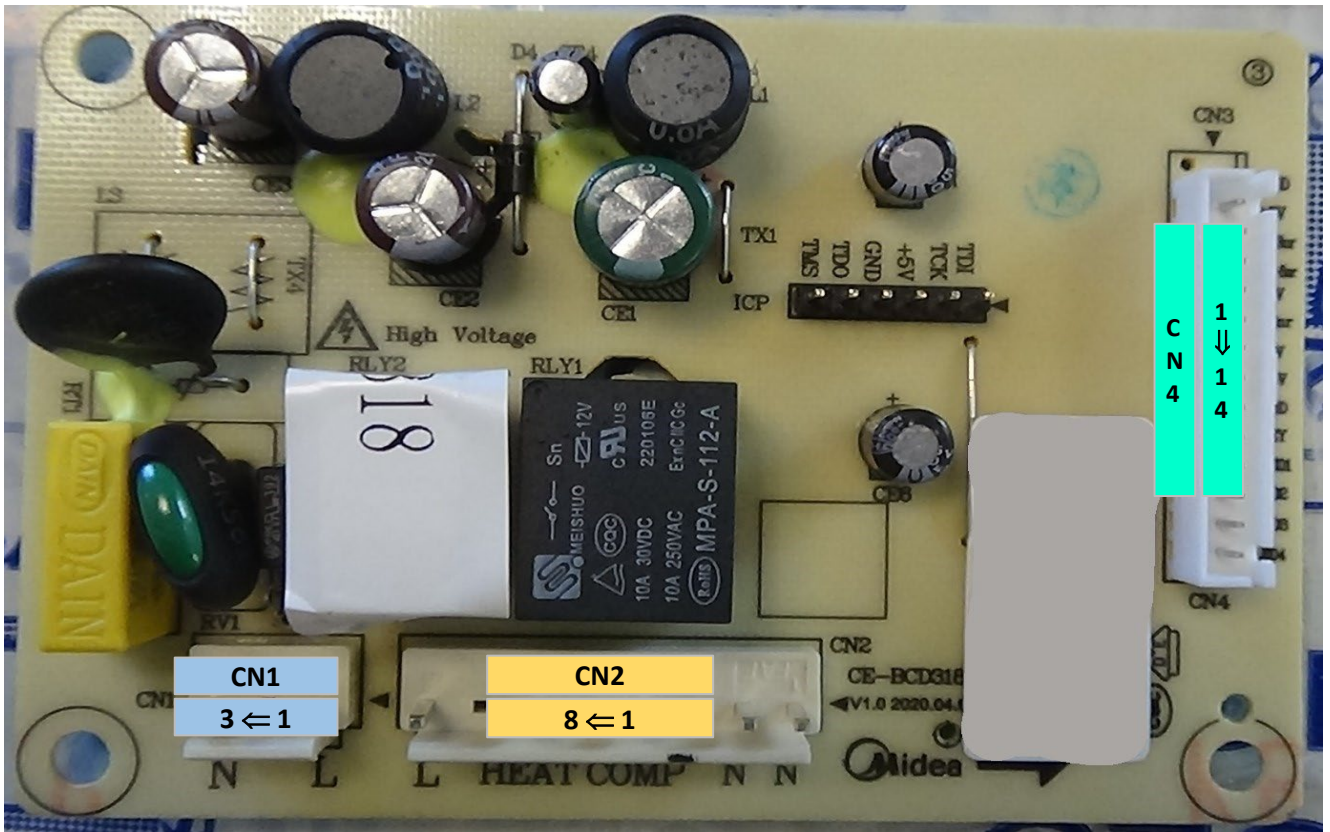

CN4	1	Gnd	-	CN1	3	N	Karmić
	2	+5V	Sonda otoczenia		2	-	
	3	A-Snr			1	L	
	4	FdSnr	Sonda odszraniania	CN2	8	L	L
	5	+5V			7	-	-
	6	R-Snr	Sonda do lodówki		6	Heat	Odporność na odszranianie
	7	+5V	-		5	-	-
	8	+5V	-		4	Comp	Kompresor
	9	Gnd	-		3	-	-
	10	KEY	-		2	N	NIE
	11	LED1	-		1	N	NIE
	12	LED2	-				
	13	LED3	-				
	14	LED4	-				

La solution assistance

SETTING

3SEC.-SUPER FRZ.

2°C

3°C

4°C

6°C

HIBAKÓD (LED-ek)	LEÍRÁS	EREDET
2°C	HŰTŐ érzékelő hibája	Ellenőrizze a vezetékeket, szondát, táblát
3°C	DEFROST érzékelő hiba	Ellenőrizze a vezetékeket, szondát, táblát
6°C	ABIENT érzékelő hibája	Ellenőrizze a vezetékeket, szondát, táblát

### Szonda értékek

(°C)	R (KΩ)	(°C)	R (KΩ)	(°C)	R (KΩ)
-30	33.81	-5	8.392	6	4.818
-25	25.17	0	6.495	8	4.372
-22	21.18	1	6.175	10	3.972
-20	18.9	2	5.873	15	3.141
-18	16.9	3	5.587	20	2.501
-16	15.12	4	5.315	25	2.005
-10	10.92	5	5.06	30	1.617

Hőmérséklet érzékelő csere FMF112010070795 : Ez a szonda általános, előfordulhat, hogy el kell vágni a hibás szonda vezetékeit, és cserekor újra kell forrasztani az újat, ha más a csatlakozó.

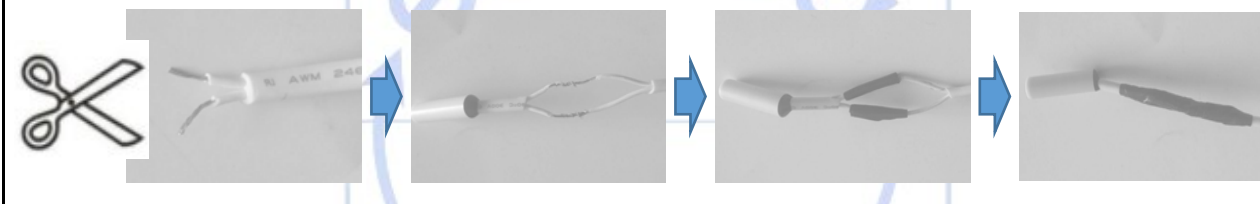

La solution assistance

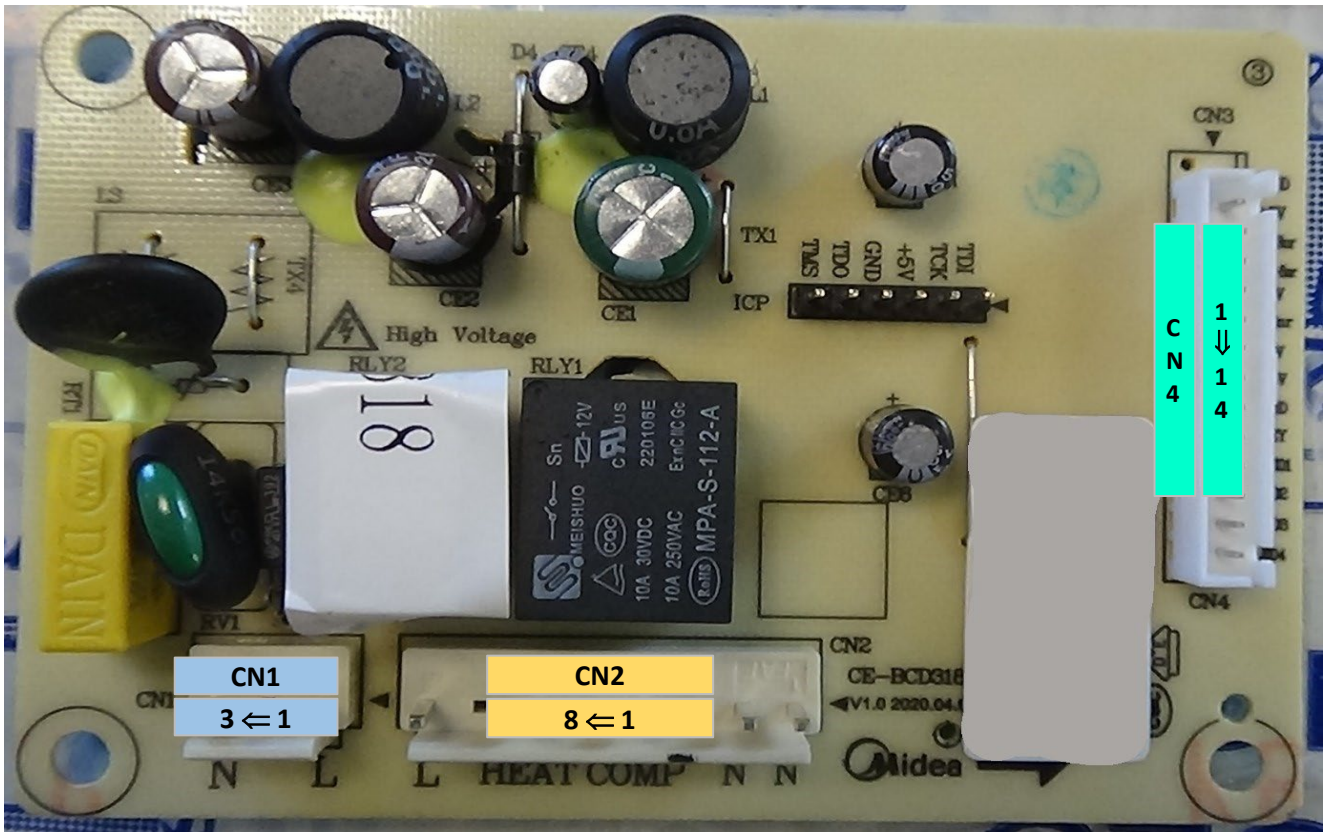

CN4	1	Gnd	-	CN1	3	N	Takarmány
	2	+5V	Környezeti szonda		2	-	
	3	A-Snr			1	L	
	4	FdSnr	Leolvasztó szonda	CN2	8	L	L
	5	+5V			7	-	-
	6	R-Snr	Hűtőszonda		6	Heat	Leolvasztási ellenállás
	7	+5V			5	-	-
	8	+5V	-		4	Comp	Kompresszor
	9	Gnd	-		3	-	-
	10	KEY	-		2	N	NEM
	11	LED1	-		1	N	NEM
	12	LED2	-				
	13	LED3	-				
	14	LED4	-				

La solution assistance

SETTING

3SEC.-SUPER FRZ.

2°C

3°C

4°C

6°C

COD DE EROARE (LED-uri)	DESCRIERE	ORIGINILE
2°C	Defecțiuni la senzorul FRIGIDERULUI	Verificați cablajul, sonda, placa
3°C	Eroare la senzorul DEGIVRARE	Verificați cablajul, sonda, placa
6°C	Eroare la senzorul AMBIENT	Verificați cablajul, sonda, placa

### Valorile sondei

(°C)	R (KΩ)	(°C)	R (KΩ)	(°C)	R (KΩ)
-30	33.81	-5	8.392	6	4.818
-25	25.17	0	6.495	8	4.372
-22	21.18	1	6.175	10	3.972
-20	18.9	2	5.873	15	3.141
-18	16.9	3	5.587	20	2.501
-16	15.12	4	5.315	25	2.005
-10	10.92	5	5.06	30	1.617

**Înlocuirea senzorului de temperatură FMF112010070795** : Această sondă este generică, poate fi necesar să tăiați firele sondei defecte și să o resedați pe cea nouă atunci când o înlocuiți dacă conectorul este diferit.

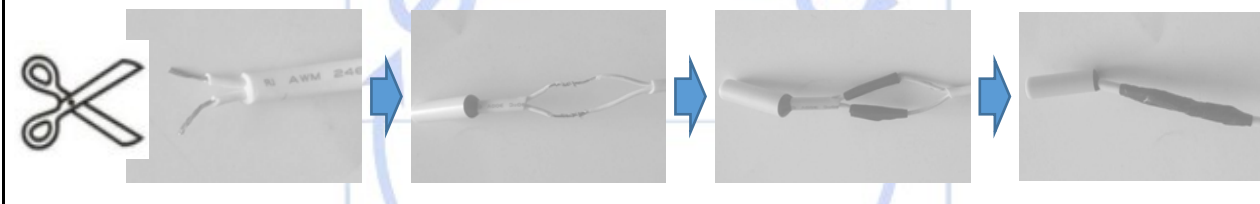

La solution assistance

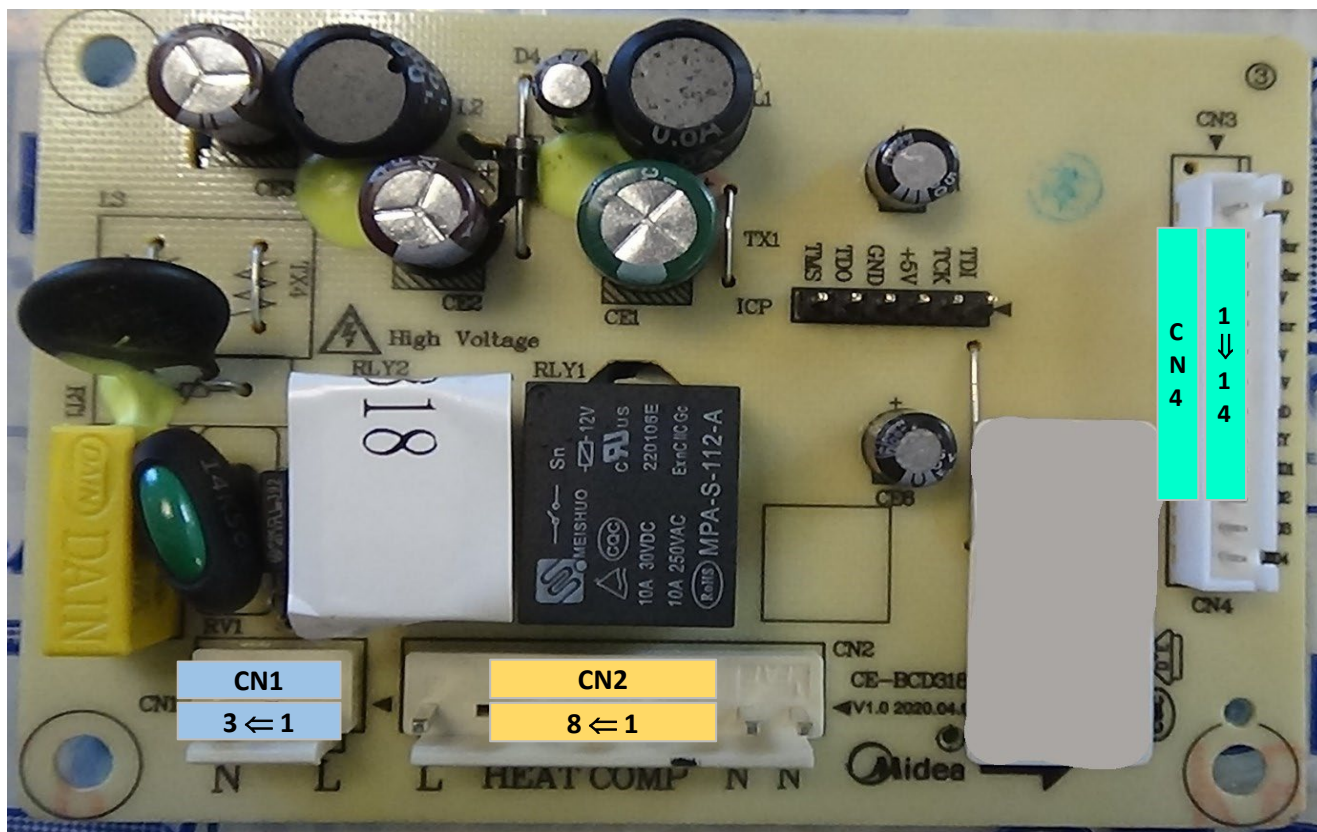

CN4	1	Gnd	-	CN1	3	N	A hrani
	2	+5V	Sondă ambientală		2	-	
	3	A-Snr			1	L	
	4	FdSnr	Sondă de dezghețare	CN2	8	L	L
	5	+5V			7	-	-
	6	R-Snr	Sonda frigider		6	Heat	Rezistența la dezghețare
	7	+5V			5	-	-
	8	+5V	-		4	Comp	Compresor
	9	Gnd	-		3	-	-
	10	KEY	-		2	N	NU
	11	LED1	-		1	N	NU
	12	LED2	-				
	13	LED3	-				
	14	LED4	-				

La solution assistance

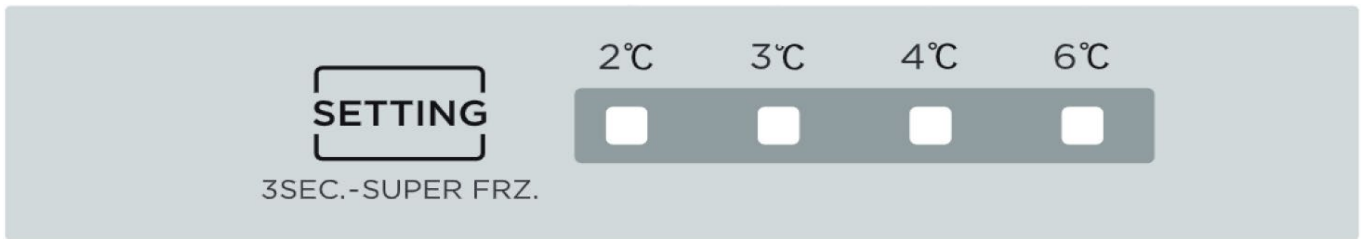

FEHLERCODE (LEDs)	BEZEICHNUNG	URSPRUNG
2 °C	KÜHLSCHRANK-Sensorfehler	Verkabelung, Sonde, Platine prüfen
3 °C	DEFROST-Sensorfehler	Verkabelung, Sonde, Platine prüfen
6 °C	Störung des Umgebungssensors	Verkabelung, Sonde, Platine prüfen

Sondenwerte					
Temperatur	R (KΩ)	Temperatur	R (KΩ)	Temperatur	R (KΩ)
-30	33.81	-5	8.392	6	4.818
-25	25.17	0	6.495	8	4.372
-22	21.18	1	6.175	10	3.972
-20	18.9	2	5.873	15	3.141
-18	16.9	3	5.587	20	2.501
-16	15.12	4	5.315	25	2.005
-10	10.92	5	5.06	30	1.617

Austausch des Temperatursensors FMF112010070795 : Diese Sonde ist generisch, Sie müssen möglicherweise die Drähte der defekten Sonde abschneiden und die neue Sonde neu anlöten, wenn Sie sie ersetzen, wenn der Stecker anders ist.

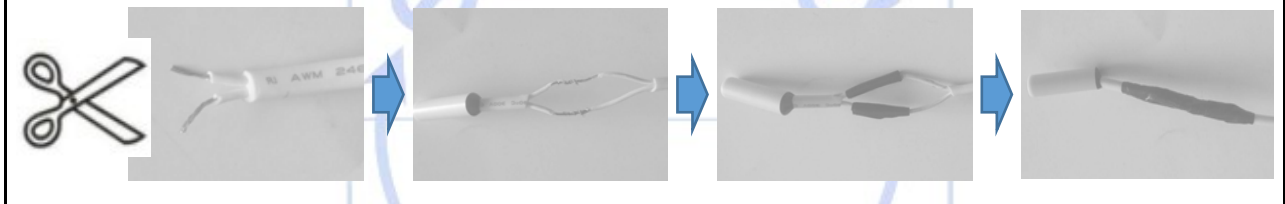

*La solution assistance*



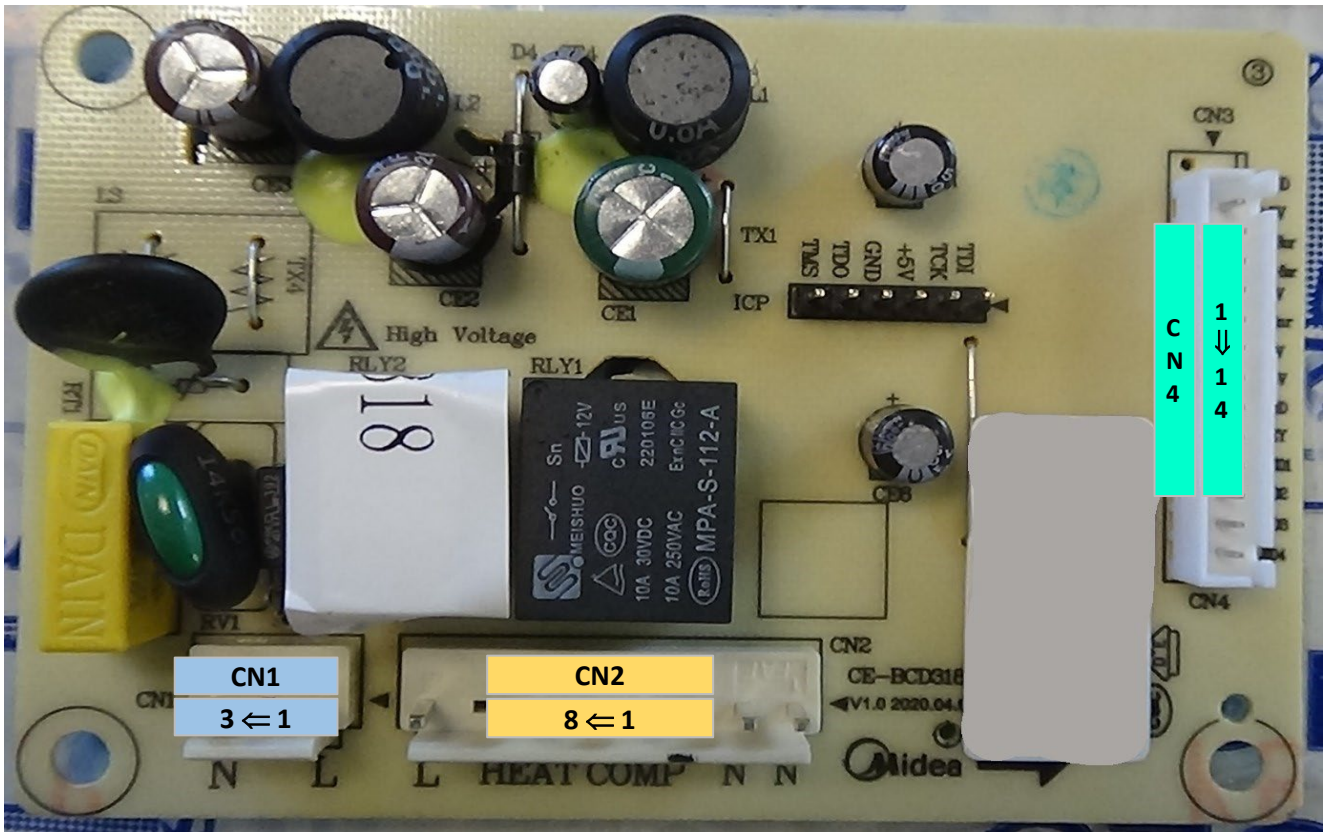

CN4	1	Gnd	-	CN1	3	N	Einspeisung
	2	+5V	Umgebungssonde		2	-	
	3	A-Snr			1	L	
	4	FdSnr	Abtaufühler	CN2	8	L	L
	5	+5V			7	-	-
	6	R-Snr	Kühlschranksonde		6	Heat	Abtaubeständigkeit
	7	+5V	-		5	-	-
	8	+5V	-		4	Comp	Kompressor
	9	Gnd	-		3	-	-
	10	KEY	-		2	N	NICHT
	11	LED1	-		1	N	NICHT
	12	LED2	-				
	13	LED3	-				
	14	LED4	-				

La solution assistance