

CUISINE **SABA**

TL712L21W

GB



CONFORAMA France SA
80 Boulevard du Mandinet
LOGNES
77432 Marne la Vallée Cedex 2
FRANCE

Thank you for choosing SABA quality. This product has been developed by our team of professional and according to European regulations. In order to get the most out of your new appliance, we recommend that you read this instruction manual carefully and keep it for future reference.

TABLE OF CONTENTS

SAFETY INSTRUCTIONS	48
PACKAGING/OLD APPLIANCE	53
INSTALLATION	54
OPERATIONS	60
MAINTENANCES	76
DISPOSAL OF OLD ELECTRICAL APPLIANCES	88

Safety instructions

- Safety Instructions

For your safety, the information in this manual must be followed to minimize the risk of fire or explosion, electric shock, or to prevent property damage, personal injury or loss of life.

Explanation of the symbols:

Warning!

This combination of symbol and signal word indicates a potentially dangerous situation which may result in death or serious injuries unless it's avoided.

GB

Caution!

This combination of symbol and signal word indicates a potentially dangerous situation which may result in slight or minor injuries or damage to property and the environment.

Note!

This combination of symbol and signal word indicates a potentially dangerous situation which may result in slight or minor injuries.

- Please insert: This appliance is intended to be used in household and similar applications such as:
 - staff kitchen areas in shops, offices and other working environments;
 - farm houses;

- by clients in hotels, motels and other residential type environments;
- bed and breakfast type environments.
- Areas for communal use in blocks of flats or in launderettes.
- This appliance is designed to wash a maximum of 7.0 kg of dry laundry

Warning!

The electric shock!

- If the supply cord is damaged, it must be replaced by the manufacturer, its service agent or similarly qualified persons in order to avoid a hazard.
- The appliance must be connected to the water distribution network by using the new connection assemblies provided with the appliance; old hose-sets should not be reused.
- Before any maintenance the device, unplug the appliance from the mains.
- Always unplug the machine and turn off the water supply after use. The max. inlet water pressure, in 1 MPa. The min. inlet water pressure, 0.05 MPa.
- To ensure your safety, power plug must be inserted into an earthed three-pole socket. Check carefully and make sure that your socket is properly and reliably earthed.
- Make sure that the water and electrical devices must be connected by a qualified technician in accordance with the manufacturer's instructions and local safety regulations.

Risk to children!

- EN countries: the appliance can be used by children aged from 8 years and above and persons with reduced physical, sensory or mental capabilities or lack of experience and knowledge if they have been given supervision or instruction concerning use of the appliance in a safe way and understand the hazards involved. Children shall not play with the appliance. Cleaning and user maintenance shall not be made by children without supervision.
- Keep children under 3 years of age away from the appliance, unless they are under constant supervision.
- Animals and children may climb into the machine. Check the machine before every operation.
- Kids should be supervised that they do not play with the appliance.
- Remove all packages and transport bolts before using the appliance. Otherwise, serious damage may result.
- Plug must be accessible after installation.

Risk of explosion!

- Do not wash or dry articles that have been cleaned in, washed in, soaked in, or dabbed with combustible or explosive substances(such as wax, oil, paint, gasoline, degreasers, dry-cleaning solvents, kerosene, etc.) This may result in fire or explosion.
- Beforehand thoroughly rinse items of washing by hand.

⚠ **Caution!**

Installing the product!

- This washing machine is for indoor use only.
- It isn't intended to be built-in using.
- The openings must not be obstructed by a carpet.
- Washing machine shall not be installed in bathrooms or very wet rooms as well as in the rooms with explosive or caustic gases.
- The washing machine with single inlet valve only can be connected to the cold water supply. The product with double inlet valves should be correctly connected to the hot water and cold water supply.
- Plug must be accessible after installation.
- Remove all packages and transport bolts before using the appliance. Otherwise, serious damage may result.

Risk of damaging appliance!

- Your product is only for home use and is only designed for the textiles suitable for machine washing.
- Do not climb up and sit on top cover of the machine.
- Do not lean against machine door.
- Cautions during Handling Machine:
 1. Transport bolts shall be reinstalled to the machine by a specialized person.
 2. The accumulated water shall be drained out of the machine.

3. Handle the machine carefully. Never hold each protruded part on the machine while lifting. Machine door cannot be used as the handle during the conveyance.
4. This appliance is heavy. Transport with care.
 - Please do not close the door with excessive forces. If it is found difficult to close the door, please check if the clothes are put in or distributed well.
 - It is forbidden to wash carpets.

Operating the appliance!

GB

- Flammable and explosive or toxic solvents are forbidden. Gasoline and alcohol etc. Shall not be used as detergents. Please only select the detergents suitable for machine washing, especially for drum.
- Make sure that all pockets are emptied. Sharp and rigid items such as coin, brooch, nail, screw or stone etc. may cause serious damages to this machine.
- Please check whether the water inside the drum has been drained before opening its door. Please do not open the door if there is any water visible.
- Be careful of burning when the product drains hot washing water.
- Never refill the water by hand during washing.
- After the program is completed, please wait for two minutes to open the door.

Packaging/Old appliance



This marking indicates that this product should not be disposed with other household wastes throughout the EU. To prevent possible harm to the environment or human health from uncontrolled waste disposal, recycle it responsibly to promote the sustainable reuse of material resources. To return your used device, please use the collection systems or contact the retailer where the product was purchased. They return and can take this product for environment-safety recycling.

Installation

- Product Description

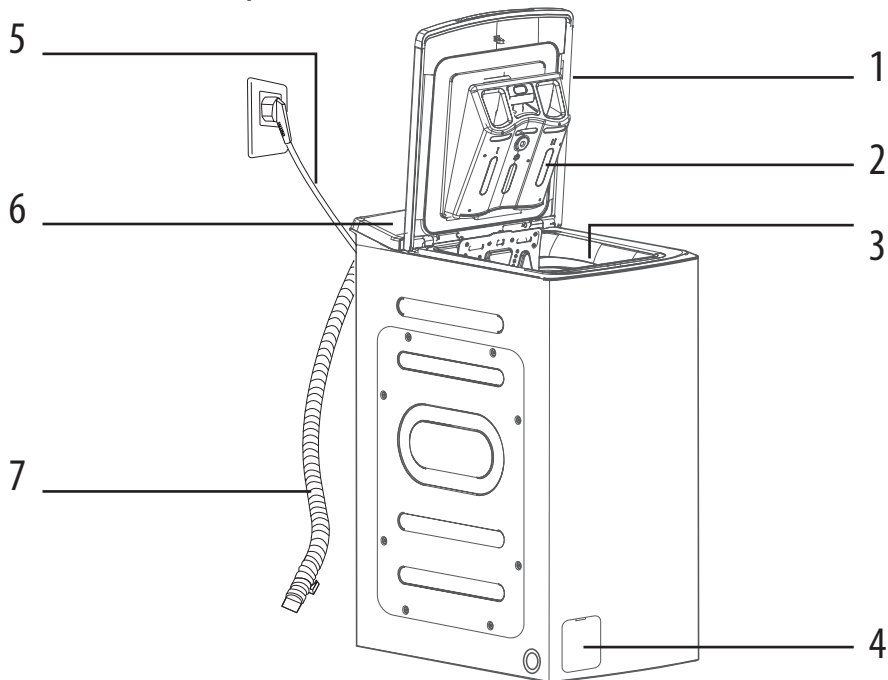

GB

- | | |
|------------------------|----------------------|
| 1. Door | 5. Power supply cord |
| 2. Detergent dispenser | 6. Control panel |
| 3. Drum | 7. Drain hose |
| 4. Service filter | |

Note!

- The product line chart is for reference only, please refer to real product as standard.

Accessories



Transport hole plug

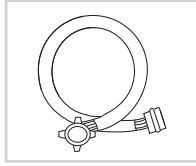

Supply hose cold water

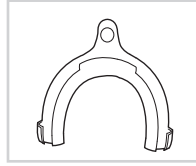

Drain hose support (optional)

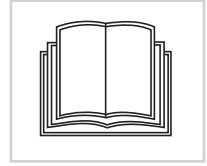

Owner's manual

Installation area

⚠ Warning!

- Stability is important to prevent the product from wandering!
- Make sure that the product should not stand on the power cord.

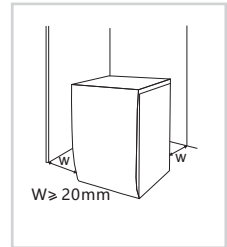

GB

Before installing the machine, the location characterized as follows shall be selected:

1. Rigid, dry, and level surface
2. Avoid direct sunlight
3. Sufficient ventilation
4. Room temperature is above 0°C
5. Keep far away from the heat resources such as coal or gas.

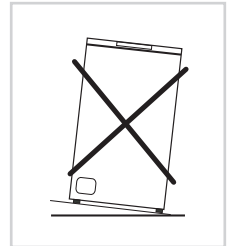

Unpacking the washing machine

⚠ Warning!

- Packaging material (e.g. Films, Styrofoam) can be dangerous for children.

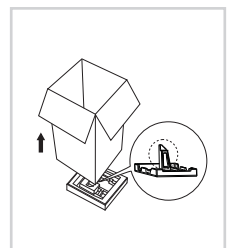

- There is a risk of suffocation! Keep all packaging well away from children.
1. Remove the cardboard box and styrofoam packing.
 2. Lift the washing machine and remove the base packing. Make sure the small triangle foam is removed with the bottom one together. If not, lay the unit down with side surface, then remove the small foam from the unit bottom manually.
 3. Remove the tape securing the power supply cord and drain hose.
 4. Remove the inlet hose from the drum.

Remove transport bolts

GB

Warning!

- You must remove the transport bolts from the backside before using the product.
- You'll need the transport bolts again if you move the product, so make sure you keep them in a safe place.

Please take the following steps to remove the bolts:

1. Loosen 4 bolts with spanner and then remove them.
2. Stop the holes with transport hole plugs.
3. Keep the transport bolts properly for future use.

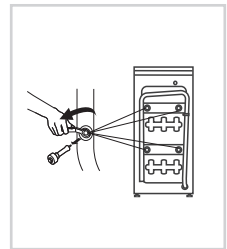

Levelling the washing machine

Warning!

- The lock nuts on all four feet must be screwed tightly against the housing.

1. Check if the legs are closely attached to the cabinet. If not, please turn them to their original positions tighten the nuts.
2. Loosen the lock nut turn the feet until it closely contacts with the floor.
3. Adjust the legs and lock them with a spanner, make sure the machine is steady.

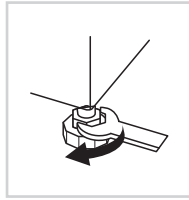
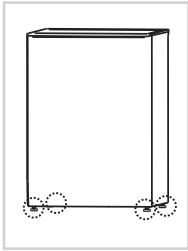

Raise

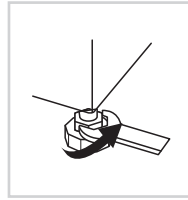

Lower

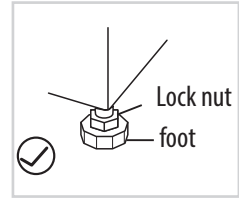

foot

Connect Water Supply Hose

⚠ Warning!

- To prevent leakage or water damage, follow the instructions in this chapter!
- Do not kink, crush, modify or sever water inlet hose.
- For the model equips hot valve, connect it to hot water tap with hot water supply hose. Energy consumption will decrease automatically for some program.

Connect the inlet pipe as indicated, There are two ways to connect the inlet pipe.

1. Connection between ordinary tap and inlet hose.

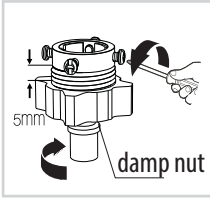

Loosen clamp nut and four bolts

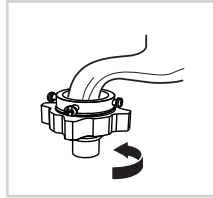

Tighten clamp nut

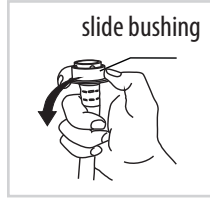

Press slide bushing, insert inlet hose into connecting base

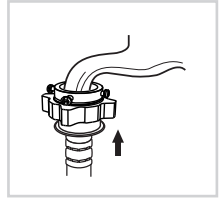

Connection finished

2. Connection between screw tap and inlet hose.

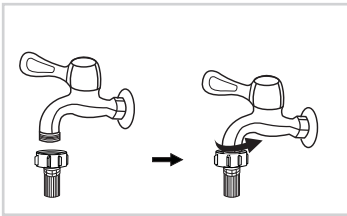

Tap with threads and inlet hose

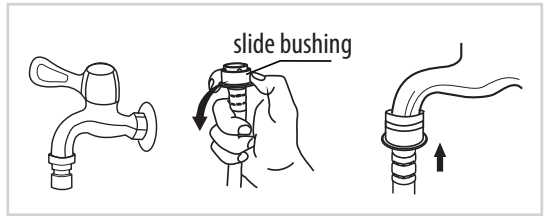

Special tap for washer dryer

Connect the other end of inlet pipe to the inlet valve at the backside of product and fasten the pipe tightly clockwise.

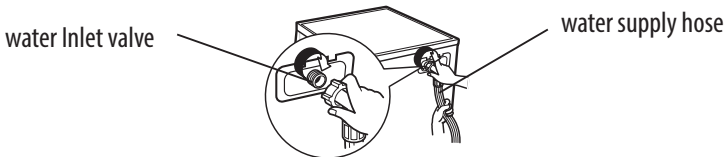

Drain Hose

⚠ Warning!

- Do not kink or protract the drain hose.
- Position drain hose properly, otherwise damage might result of water leakage.

There are two ways to place the end of drain hose:

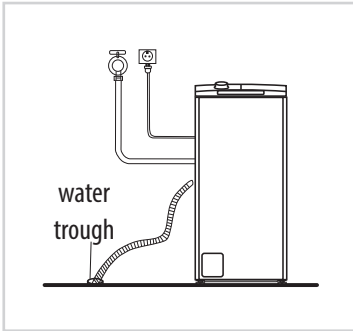

1. Put it into the water trough.

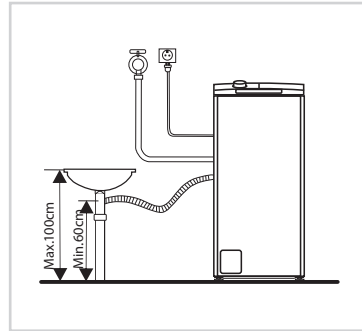

2. Connect it to the branch drainpipe of the trough.

📌 Note!

- If the machine has drain hose support, please install it like the following .

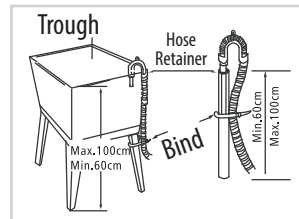
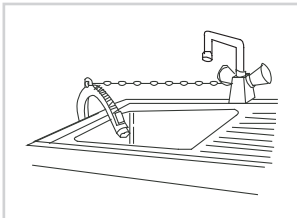

⚠ Warning!

- When installing drain hose, fix it properly with a rope.
- If drain hose is too long, do not force it into washing machine as it will cause abnormal noises.

Operations

Quick Start

⚠ Caution!

- Before washing, please make sure it's installed properly.

GB

1. Before Washing

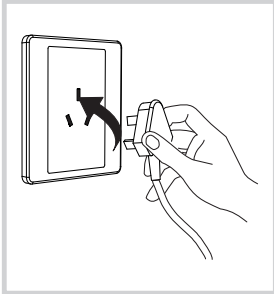

Plug in

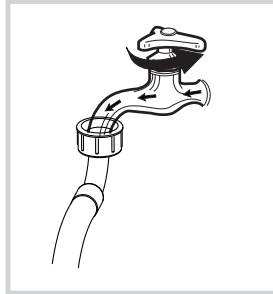

Open tap

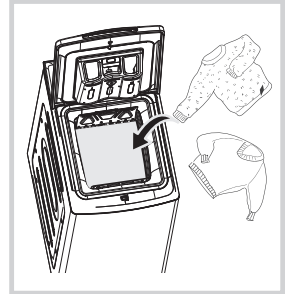

Load

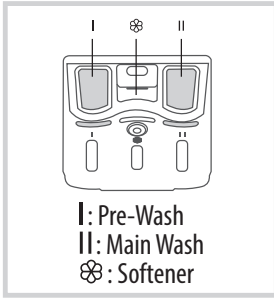

Add detergent

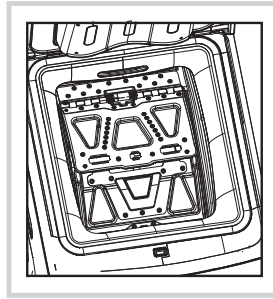

Close drum door

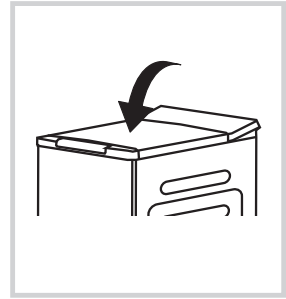

Close machine door

Note!

- Detergent need to be added in “case I” after selecting pre-washing for machines with this function.
- Make sure that the drum flaps are properly locked.
- All metal hooks must be properly hooked inside the rear door flap.
- Check the roller before each laundry, it must roll smoothly.

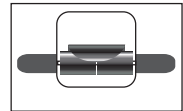
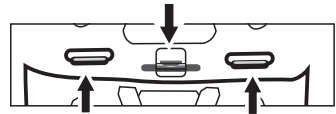

GB

2. Washing

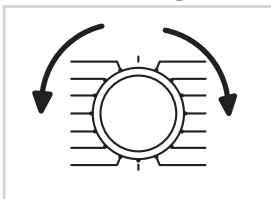

Select Programme

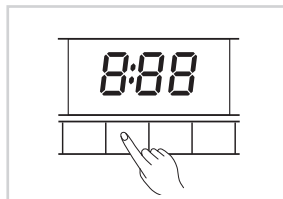

Select function or default



Start

Note!

- If default is selected, step 2 can be skipped.

3. After Washing

“End” on display.

Before Each Washing

- The working condition of the washer should be (0-40)°C. If used under 0°C, the inlet valve and draining system may be damaged. If the machine is placed under condition of 0°C or less, then it should be transferred to normal ambient temperature to ensure the water supply hose and drain hose are not frozen before use.
- Please check the labels and the explanation of using detergent before wash. Use non-foaming or less-foaming detergent suitable for machine washing properly.

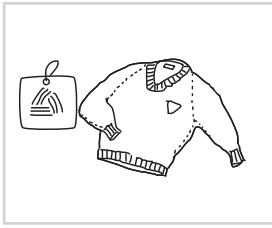

Check the label

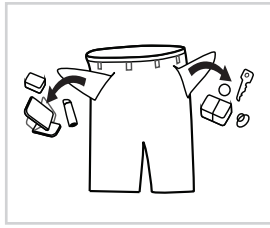

Take out the items out of the pockets

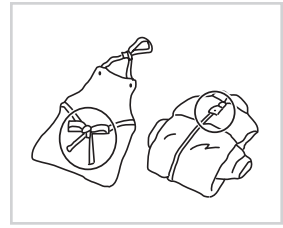

Knot the long strips.zip or button

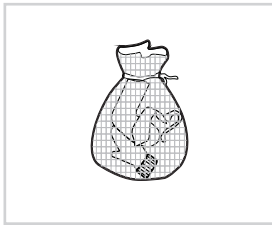

Put small clothes into the pillowslip

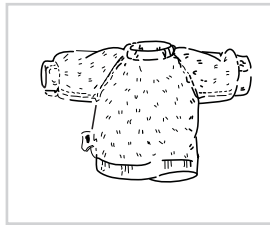

Turn easy-pilling and long-pile fabric inside out

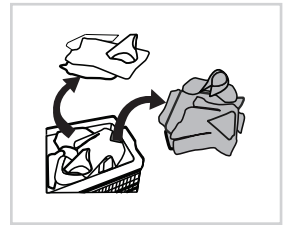

Separate clothes with different textures

Warning!

- When washing a single clothes, it may easily cause great eccentricity and give alarm due to great unbalance. Therefore it is suggested to add one or two more clothes to be washed together so that draining can be done smoothly.
- Don't washing the clothes touching with kerosene, gasoline, alcohol and other flammable materials.

Detergent Dispenser

- I** Pre-Wash detergent
- II** Main Wash detergent
-  Softener

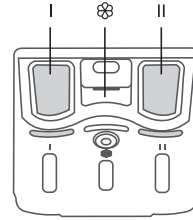



Pull out the dispenser

⚠ Caution!

GB

- Detergent only need to be added in “case I” after selecting pre-washing for machines with this function.
- Do not exceed the “MAX” level mark when filling in detergent, additives or softener.

Programme	I	II	
Cotton	○	●	○
Synthetic	○	●	○
Mix	○	●	○
Jeans	○	●	○
Sportswear	○	●	○
Drum Clean			
20°C		●	○
Intensive		●	○

Programme	I	II	
Spin Only			○
Rinse & Spin		●	○
Wool		●	○
Daily Wash 45'	○	●	○
Quick 15'		●	○
ECO 40-60		●	○
Rapid 45'	○	●	○

● Means must ○ Means optional

Note!

- As for the agglomerated or ropy detergent or additive, before they are poured into the detergent box, it is suggested to use some water for dilution to prevent the inlet of detergent box from being blocked and overflowing while filling water.
- Please choose suitable type of detergent for the various washing temperature to get the best washing performance with less water and energy consumption.

Control Panel

Model: TL712L21W

GB

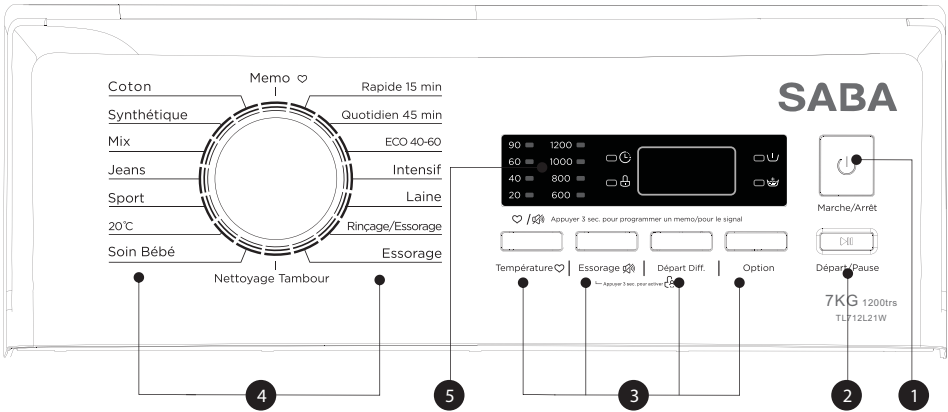

Note!

- The chart is for reference only, Please refer to real product as standard.

① On/off

Product is switched On/Off.

② Start/Pause

Press the button to start or pause the washing cycle.

③ Option

This allows you to select an additional function and will light when selected.

④ Programmes

Available according to the laundry type.

⑤ Display

The display shows the settings, estimated time remaining, options, and status messages for your washer. The display will remain on through the cycle.

GB

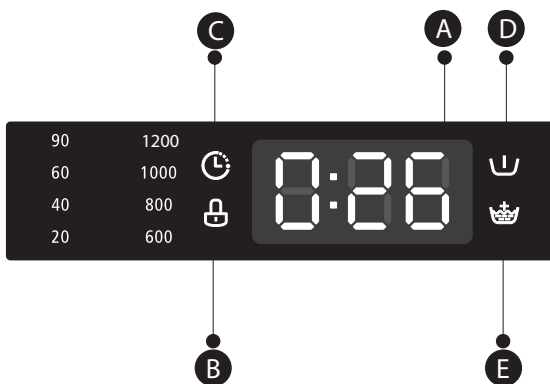

A Display

Wash Time 1:25

Delay Time 2H

End End

Error End

B Door Lock

C Delay

D Pre Wash

E Extra Rinse

GB

Option

Pre Wash

Pre Wash

The Prewash function can get an extra wash before main wash, it is suitable for washing the dust rises to surface of the clothes; You need to put detergent into the Case (I) when select it.

Extra Rinse

Extra Rinse

The laundry will undergo extra rinse once after you select it.

Delay

Delay

Set the Delay function:

1. Select a programme;
2. Press the Delay button to choose the time (the delaying time is 0-24 H/3H-6H-9H);
3. Press [Start/Pause] to commence the delay operation



Choose the Programme



Setting time



Start

Cancel the Delay function:

Press the [Delay] button until the display be 0H. It should be pressed before starting the programme. If the programme already started, should switch off programme to reset a new one.

⚠ Caution!

- If there is any break in the power supply while the machine is operating, a special memory stores the selected programme and when the power is restarted, the program will continue.

Model:
TL712L21W

Programme	Option	Programme	
	Delay	Extra rinse	Pre wash
Cotton	<input type="radio"/>	<input type="radio"/>	<input type="radio"/>
Quick 15'	<input type="radio"/>		
Rapid 45'	<input type="radio"/>	<input type="radio"/>	<input type="radio"/>
ECO 40-60	<input type="radio"/>		
Intensive	<input type="radio"/>		
20°C	<input type="radio"/>	<input type="radio"/>	
Rinse & Spin	<input type="radio"/>	<input type="radio"/>	
Spin Only	<input type="radio"/>		
Drum Clean	<input type="radio"/>		
Baby Care	<input type="radio"/>	<input type="radio"/>	<input type="radio"/>
Sportswear	<input type="radio"/>	<input type="radio"/>	<input type="radio"/>
Jeans	<input type="radio"/>	<input type="radio"/>	<input type="radio"/>
Wool	<input type="radio"/>	<input type="radio"/>	
Synthetic	<input type="radio"/>	<input type="radio"/>	<input type="radio"/>
Mix	<input type="radio"/>	<input type="radio"/>	<input type="radio"/>

GB

○ Means optional (Some models have intelligent weighing function, please refer to the actual product)

Other Functions

Temp.

Temp.

Press the button to regulate the temperature
(Cold,20°C, 40°C,60°C,90°C)

Spin

Spin

Press the button to change the speed. 1200:
0-600-800-1000-1200

Model:

TL712L21W

GB

Programme	Default Speed (rmp)	
	1200	
Cotton	1200	
Quick 15'	800	
Rapid 45'	800	
ECO 40-60	1200	
Intensive	800	
20C	1000	
Rinse & Spin	800	
Spin Only	800	
Drum Clean	-	
Baby Care	800	
Sportswear	800	
Jeans	800	

Programme	Default Speed (rpm)	
Wool	600	
Synthetic	1200	
Mix	800	



Child Lock

To avoid mis operation by children.



Choose the
Programme



Start

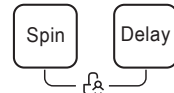

Press [Spin] and [Delay]
3 sec. till buzzer beep.

GB

⚠ Caution!

- During the “Child Lock” function is activating, the buzzer will beep 3 times, when the buttons are pressed.
- Press the two button 3sec. also to be released the function.
- The “Child Lock” will lock all buttons except Power button.
- Cut off the power supply, the kid’s protection is to be released.



Child Lock

To avoid mis operation by children.



Choose the Programme



Press the [Spin]button for 3sec., the buzzer is mute.

⚠ Caution!

- After Muting the buzzer function, the sounds will not be activated any more.

GB



My Cycle

To memory the frequently used programme.

After choosing the programme and setting the options, press [Temp.] 3 sec. before start to wash. The default setting course is Cotton.

Programmes

Programmes are available according to the laundry type.

Programmes	
Cotton	Hard-wearing textiles, heat-resistant textiles made of cotton or linen.
Synthetic	Wash synthetic articles, for example: shirts, coats, blending. While washing the knitting textiles, detergent quantity shall be reduced due to its loose string construction and easily forming bubbles.
Baby Care	Washing the baby's clothes, it can make the baby's wear cleaner and make the rinse performance better to protect the baby skin.
Rapid 45'	Washing few and not very dirty clothes quickly.
Mix	Mixed load consisting of textiles made of cotton and synthetics.
Sportswear	Washing the activewear.
Jeans	Specially for jeans.
Quick 15'	Extra short programme approx, suitable for lightly soiled washing as a small amounts of laundry.

Wool	Hand or machine-washable wool or richwool textiles. Especially gentle wash programme to prevent shrinkage, longer programme pauses (textiles rest in wash liquor).
Spin Only	Extra spin with selectable spin speed.
Rinse & Spin	Extra rinse with spin.
Drum Clean	Specially set in this machine to clean the drum and tube. It applies 90 °C high temperature sterilization to make the clothes washing more green. When this programme is performed, the clothes or other washing cannot be added. When proper amount of chlorine bleaching agent is put in, the barrel cleaning effect will be better. The customer can use this programme regularly according to the need.
ECO 40-60	Default 40c, not selectable, suitable for laundry washing at about 40C-60C.
Intensive	To increase the washing effects, washing time is increased.
20°C	Washing brightly colored clothes, it can protect the colors better

Washing Programmes Table

TL712L21W

Programme	Load(kg)	Temp.(°C)	Default Time
			7.0
Cotton	7.0	40	2:40
Synthetic	3.5	40	2:20
Mix	7.0	40	1:37
Jeans	7.0	60	1:45
Sportswear	3.5	40	1:31
20°C	3.5	20	1:01
Baby Care	7.0	60	1:42
Drum Clean	-	90	1:18
Spin Only	7.0	--	0:12
Rinse & Spin	7.0	--	0:20
Wool	2.0	40	1:07
Intensive	7.0	40	3:48
ECO 40_60	7.0	--	3:25
Rapid 45'	2.5	40	0:45
Quick 15'	2.0	Cold	0:15

- Concerning to EN 60456:2016/prA2019 With (EU)2019/2014, (EU)2019/2023, The EU energy efficiency class is: D
Energy test program: ECO 40-60. Other as the default.
Half load for 7.0Kg machine:3.5Kg.
Quarter load for 7.0Kg machine:2.0Kg.

Note!

- The parameters in this table are only for user's reference. The actual parameters may be different with the parameters in above mentioned table.

Maintenances

Cleaning And Care

⚠ Warning!

- Before your maintenance starts, please unplug the machine and close the tap.

Cleaning The Cabinet

Proper maintenance on the washing machine can extend its working life. The surface can be cleaned with diluted non-abrasive neutral detergents when necessary. If there is any water overflow, use the wet cloth to wipe it off immediately.

No sharp items are allowed.

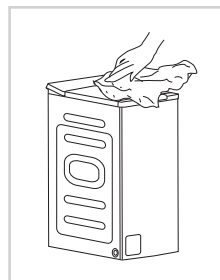

Note!

- Formic acid and its diluted solvents or equivalent are forbidden, such as alcohol, solvents or chemical products, etc.

Cleaning The Drum

The rusts left inside the drum by the metal articles shall be removed immediately with chlorine-free detergents. Never use steel wool.

Note!

- Don't put laundry in the washing machine during the drum cleaning.

GB

Cleaning The Inlet Filter

Note!

- Inlet filter must be cleaned if there is less water.

Washing the filter in the tap

1. Close the tap.
2. Remove the water supply hose from the tap
3. clean the filter.
4. Reconnect the water supply hose.

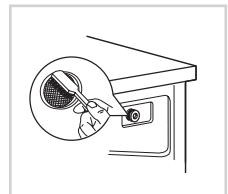
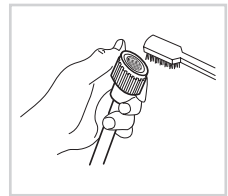
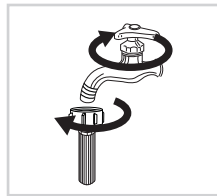

Washing the filter in washing machine:

1. Screw off the inlet pipe from the backside of the machine.
2. Pull out the filter with long nose pliers and reinstall it back after being washed.
3. Use the brush to clean the filter.
4. Reconnect the inlet pipe.

Note!

- If the brush is not clean, you can pull out the filter washed separately;
- Reconnect, turn on the tap.

GB

Clean The Detergent Dispenser

1. Press down the arrow location on softener cover inside the dispenser drawer.
2. Lift the clip up and take out softener cover and wash all grooves with water.
3. Restore the softener cover and push the drawer onto position.

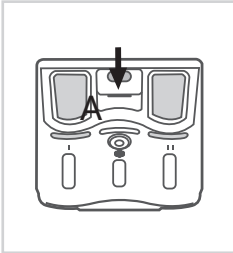

Pull out the dispenser drawer with press the A

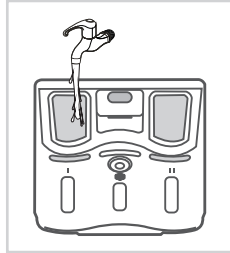

Clean the dispenser drawer under water

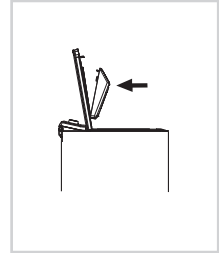

Clean inside the recess with an old toothbrush

Note!

- Do not use alcohol, solvents or chemical products to clean the machine.

Cleaning The Drain Pump Filter

Warning!

- Be careful of the hot water!
- Allow detergent solution to cool down.
- Unplug the machine to avoid electrical shock before washing.
- Drain pump filter can filter the yarns and small foreign matters from the washing.
- Clean the filter periodically to ensure the normal operation of washing machine.

GB

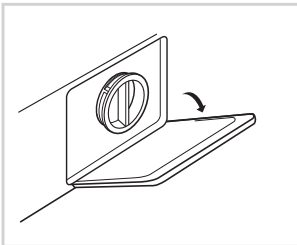

Open the lower cover cap

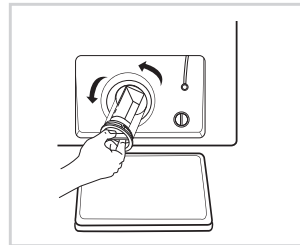

Open the filter by turning to the counterclockwise

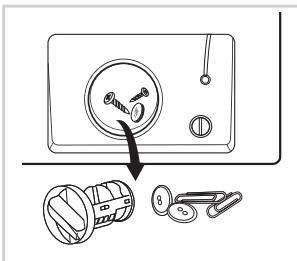

Remove extraneous matter

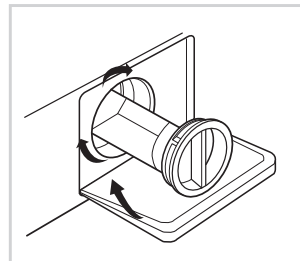

Close the lower cover cap

⚠ Caution!

- Make sure that valve cap and emergency drain hose are reinstalled properly, cap plates should be inserted aligning to hole plates otherwise water may leak.
- When the appliance is in use and depending on the programme selected there can be hot water in the pump. Never remove the pump cover during a wash cycle, always wait until the appliance has finished the cycle, and is empty. When replacing the cover, ensure it is securely re-tightened.

Trouble Shooting

GB

The start of the appliance does not work or it stops during operation.

First try to find a solution to the problem, If not, contact the service centre.

Description	Reason	Solution
Washing machine cannot start up	Door is not closed properly	Restart after the door is closed Check if the clothes is stuck
Door can't be opened	Washer's safety protection design is working	Disconnect the power, restart the product
Water leakage	The connection between inlet pipe or outlet hose is not tight	Check and fasten water pipes Clean up outlet hose

Description	Reason	Solution
Detergent residues in the box	Detergent is dampened or agglomerated	Clean and wipe the detergent box
Indicator or display does not light	Disconnect the power PC board or harness has connection problem	Check if the power is shut down and the power plug is connected correctly
Abnormal noise		Check if the fixing (bolts) have been removed

LED display models:		
Description	Reason	Solution
E30	Door is not closed properly	Restart after the door is closed Check if the clothes is stuck
E10	Water injecting problem while washing	Check if the water pressure is too low Straighten the water pipe Check if the inlet valve filter is blocked
E21	Overtime water draining	Check if the drain hose is blocked

LED display models:		
Description	Reason	Solution
E12	Water overflow	Restart the washer
EXX	Others	Please try again first, call up service line if there are still troubles

Note!

- After the check, activate the appliance. If the problem occurs or the display shows other alarm codes again, contact the service.

GB

Technical Specifications

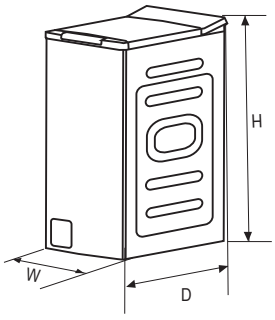
Power Supply	220-240V~,50Hz	
MAX. Current	10A	
Standard Water Pressure	0.1 MPa~1 MPa	

Model	Washing Capacity Drying Capacity	Dimension (W*D*Hmm)	Net Weight	Rated Power
TL712L21W	7.0kg	400*610*875	56kg	2100W

Product fiche

Supplier's name or trade mark: SABA				
Supplier's address ^(b) : 80 Boulevard du Mandinet LOGNES 77432 Marne la Vallée Cedex 2 FRANCE				
Model identifier: TL712L21W				
General product parameters:				
Parameter	Value	Parameter	Value	
Rated capacity (kg)	7.0	Dimensions in cm	Height	88
			Width	40
			Depth	61
EElw (°)	80.0	Energy efficiency class (°)	D	
Washing efficiency index	1.04	Rinsing effectiveness (g/kg) 0	5.0	
Energy consumption in kWh per cycle, based on the eco 40-60 programme. Actual energy consumption will depend on how the appliance is used.	0.69	Water consumption in litre per cycle, based on the eco 40-60 programme. Actual water consumption will depend on how the appliance is used and on the hardness of the water.	45	

GB

Maximum temperature inside the treated textile (*) (°C)	Rated washing capacity	36	Remaining moisture content 0 (%)	Rated capacity	62
	Half	29		Half	62
	Quarter	23		Quarter	62
Spin speed f) (rpm)	Rated capacity	1200	Spin-drying efficiency class (a)	C	
	Half	1200			
	Quarter	1200			
Programme duration (a) (h:min)	Rated washing capacity	3:28	Type	free-standing	
	Half	2:42			
	Quarter	2:42			
Airborne acoustical noise emissions in the spinning phase (a) (dB(A) re 1 pW)	80		Airborne acoustical noise emission class 0 (spinning phase)	C	
Off-mode (W)	0.50		Standby mode (W)	1.00	
Delay start (W) (if applicable)	4.00		Networked standby (W) (if applicable)	N/A	
Minimum duration of the guarantee offered by the supplier :24 months					
This product has been designed to release silver ions during the washing cycle			NO		
Additional information:					
Weblink to the supplier's website, where the information in point 9 of Annex II to Commission Regulation (EU) 2019/2023 (1) (b) is found: www.conforama.fr					
(a) for the eco 40-60 programme. (b) changes to these items shall not be considered relevant for the purposes of paragraph 4 of Article 4 of Regulation (EU) 2017/1369. (c) if the product database automatically generates the definitive content of this cell the supplier shall not enter these data.					

Note!

- Programme setting for testing in accordance with applicable standard En60456.
- When using the test programmes, wash the specified load using the maximum spin speed.
- The actual parameters will depend on how the appliance is used, and maybe different with the parameters in above mentioned table.
- The household washing machine is equipped with power management system. The duration of the left-on mode time is less than 10 minutes.
- The noise emissions during washing/spinning for the standard washing cycle at full load.

Disposal of old electrical appliances



The European directive 2012/19/EU on Waste Electrical and Electronic Equipment (WEEE), requires that old household electrical appliances must not be disposed of in the normal unsorted municipal waste stream. Old appliances must be collected separately in order to optimize the recovery and recycling of the materials they contain, and reduce the impact on human health and the environment.

GB

The crossed out “wheeled bin” symbol on the product reminds you of your obligation, that when you dispose of the appliance, it must be separately collected.

Consumers should contact their local authority or retailer for information concerning the correct disposal of their old appliance.



SABA is a trademark of Technicolor or its affiliates used under license by Conforama.



SABA is a German brand born in 1923 in the heart of the Black Forest.

A pioneer in electronic equipment, it continues offering innovative and high quality products that will accompany you on a daily basis.



PENSEZ AU TRI !
ENSEMBLE RÉDUISONS
L'IMPACT ENVIRONNEMENTAL
DES EMBALLAGES

CARDBOARD
ELEMENT

A JETER

PLASTIC
ELEMENT

A RECYCLER



CONSIGNE POUVANT VARIER LOCALEMENT > WWW.CONSIGNESDETRI.FR