



LF912RL21W

INSTRUCTION MANUAL

LF912RL21W

Use all instructions and explanations of the installation before use. Follow the instructions carefully. Keep the operation instructions handy for later use. If the application is sold or passed on, then ensure that the new owner always receives those operation instructions.

TABLE OF CONTENTS

SAFETY INSTRUCTIONS.....	GB-2
INSTALLATION.....	GB-8
OPERATIONS.....	GB-16
Quick Start.....	GB-16
Before Each Washing.....	GB-18
Detergent Dispenser.....	GB-19
Control Panel.....	GB-21
Option.....	GB-24
Other Functions.....	GB-26
Programmes.....	GB-30
Washing Programmes Table.....	GB-32
MAINTENANCES.....	GB-34
Cleaning And Care.....	GB-34
Troubleshooting.....	GB-40
Technical Specifications.....	GB-43
Product fiche.....	GB-44
DISPOSAL OF OLD ELECTRICAL APPLIANCES.....	GB-50

SAFETY INSTRUCTIONS

For your safety, the information in this manual must be followed to minimize the risk of fire or explosion, electric shock, or to prevent property damage, personal injury or loss of life. Explanation of the symbols:

Warning!

This combination of symbol and signal word indicates a potentially dangerous situation which may result in death or serious injuries unless it's avoided.

Caution!

This combination of symbol and signal word indicates a potentially dangerous situation which may result in slight or minor injuries or damage to property and the environment.

Note!

This combination of symbol and signal word indicates a potentially dangerous situation which may result in slight or minor injuries.

Warning!

The electric shock!

- If the supply cord is damaged, it must be replaced by the manufacturer, its service agent or similarly qualified persons in order to avoid a hazard.
- The device must be connected to the water distribution network using the new connection sets supplied with the device; used connection sets must not be reused.
- Before any maintenance the device, unplug the appliance from the mains.
- Always unplug the machine and turn off the water supply after use. The max. inlet water pressure, in 1 MPa. The min. inlet water pressure, in 0.05 MPa.
- To ensure your safety, power plug must be inserted into an earthed three-pole socket. Check carefully and make sure that your socket is properly and reliably earthed.
- Make sure that the water and electrical devices must be connected by a qualified technician in accordance with the manufacturer's instructions and local safety regulations.

Risk to children!

- This appliance can be used by children aged from 8 years and above and persons with reduced physical, sensory or mental capabilities or lack of experience and knowledge if they have been given supervision or instruction concerning use of the appliance in a safe way and understand the hazards involved. Children shall not play with the appliance. Cleaning and user maintenance shall not be made by children without supervision.
- Children under 3 years of age should be kept away, unless they are under continuous supervision.
- Animals and children may climb into the machine. Check the machine before every operation.
- Kids should be supervised that they do not play with the appliance.
- Glass door may be very hot during the operation. Keep kids and pets far away from the machine during the operation very wet rooms as well as in the rooms with explosive or caustic gas.

- Remove all packages and transport bolts before using the appliance. Otherwise, serious damage may result.
- Plug must be accessible after installation.

Risk of explosion!

- Do not wash or dry articles that have been cleaned in, washed in, soaked in, or dabbed with combustible or explosive substances (such as wax, oil, paint, gasoline, degreasers, dry-cleaning solvents, kerosene, etc.) This may result in fire or explosion.
- Beforehand thoroughly rinse items of washing by hand.

⚠ Caution!

Installing the product!

- This washing machine is for indoor use only.
- It isn't intended to be built-in using.
- The openings must not be obstructed by a carpet.
- Washing machine shall not be installed in bathroom or very wet rooms as well as in the rooms with explosive or caustic gases.

- The washing machine with single inlet valve only can be connected to the cold-water supply. The product with double inlet valves should be correctly connected to the hot water and cold-water supply.
- Plug must be accessible after installation.
- Remove all packages and transport bolts before using the appliance. Otherwise, serious damage may result. Risk of damaging appliance!

Risk of damaging appliance

- Your product is only for home use and is only designed for the textiles suitable for machine washing.
- Do not climb up and sit on top cover of the machine.
- Do not lean against machine door.
- Cautions during Handling Machine:
 1. The accumulated water shall be drained out of the machine.
 2. Handle the machine carefully. Never hold each protruded part on the machine while lifting. Machine door cannot be used as the handle during the conveyance.

3. This appliance is heavy. Transport with care.
 - Please do not close the door with excessive forces. If it is found difficult to close the door, please check if the clothes are put in or distributed well.
 - It is forbidden to wash carpets.

Operating the appliance!

- Before washing the clothes at first time, the product shall be operated in one round of the whole procedures without the clothes inside.
- Flammable and explosive or toxic solvents are forbidden. Gasoline and alcohol etc. Shall not be used as detergents. Please only select the detergents suitable for machine washing, especially for drum.
- Make sure that all pockets are emptied. Sharp and rigid items such as coin, brooch, nail, screw or stone etc. may cause serious damages to this machine.
- Please check whether the water inside the drum has been drained before opening its door. Please do not open the door if there is any water visible.
- Be careful of burning when the product drains hot washing water.

- Never refill the water by hand during washing.
- After the program is completed, please wait for two minutes to open the door.

INSTALLATION

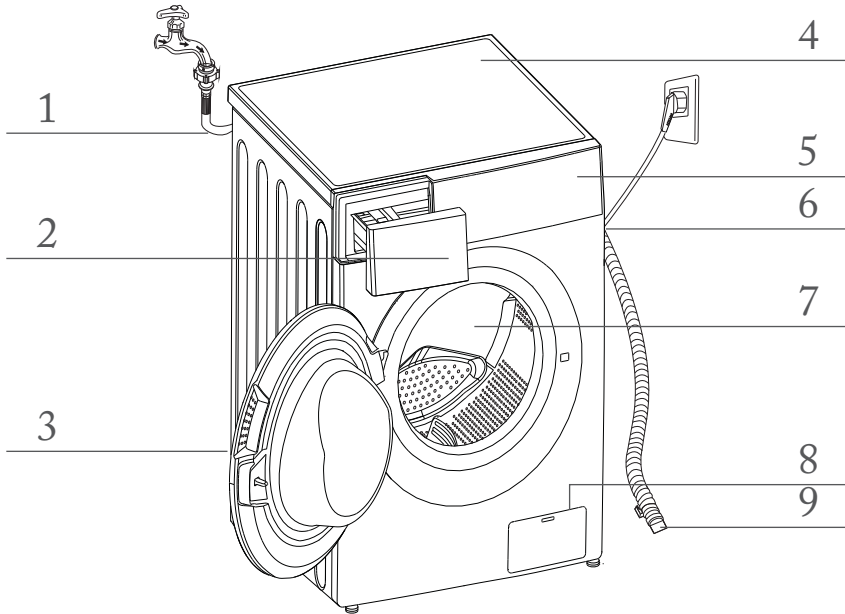





- | | |
|------------------------|----------------------|
| 1. Water supply hose | 5. Control panel |
| 2. Detergent dispenses | 6. Power supply cord |
| 3. Door | 7. Drum |
| 4. Top cover | 8. Service filter |
| | 9. Drain hose |

⚠ Note!

- The product line chart is for reference only, please refer to real product as standard.

Accessories

				
Transport hole plug	Supply hose cold water	Supply hose hot water (optional)	Drain hose support (optional)	Owner's manual

Installation area

⚠ Warning!

- Stability is important to prevent the product from wandering!
- Make sure that the product should not stand on the power cord.

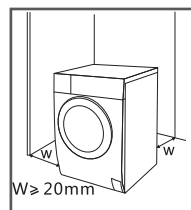

Before installing the machine, the location characterized as follows shall be selected:

1. Rigid, dry, and level surface
2. Avoid direct sunlight
3. Sufficient ventilation
4. Room temperature is above 0°C
5. Keep far away from the heat resources such as coal or gas.

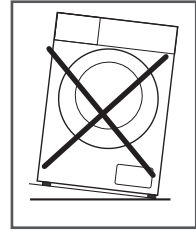

Unpacking the washing machine

 Warning!

- Packaging material (e.g. Films, Styrofoam) can be dangerous for children.
- There is a risk of suffocation! Keep all packaging well away from children.

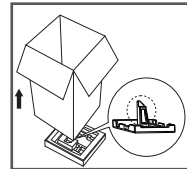

1. Remove the cardboard box and Styrofoam packing.
2. Lift the washing machine and remove the base packing. Make sure the small triangle foam is removed with the bottom one together. If not, lay the unit down with side surface, then remove the small foam from the unit bottom manually.
3. Remove the tape securing the power supply cord and drain hose.
4. Remove the inlet hose from the drum.

Remove transport bolts

Warning!

- You must remove the transport bolts from the backside before using the product.
- You'll need the transport bolts again if you move the product, so make sure you keep them in a safe place.

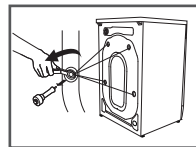

Please take the following steps to remove the bolts:

1. Loosen 4 bolts with spanner and then remove them.
2. Stop the holes with transport hole plugs.
3. Keep the transport bolts properly for future use.

Levelling the washing machine **Warning!**

 **Warning!**

- The lock nuts on all four feet must be screwed tightly against the housing.
1. Check if the legs are closely attached to the cabinet. If not, please turn them to their original positions tighten the nuts.
 2. Loosen the lock nut turn the feet until it closely contacts with the floor.
 3. Adjust the legs and lock them with a spanner, make sure the machine is steady.

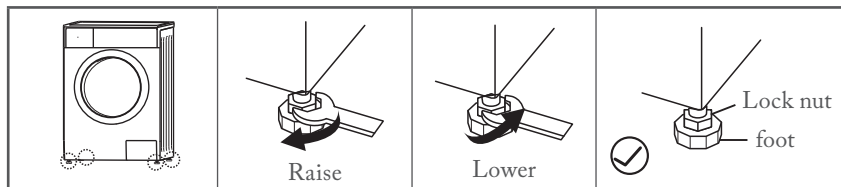

Connect Water Supply Hose

⚠ Warning!

- To prevent leakage or water damage, follow the instructions in this chapter!
- Do not kink, crush, modify or sever water inlet hose.
- For the model equips hot valve, connect it to hot water tap with hot water supply hose. Energy consumption will decrease automatically for some program.

Connect the inlet pipe as indicated, there are two ways to connect the inlet pipe.

1. Connection between ordinary tap and inlet hose.

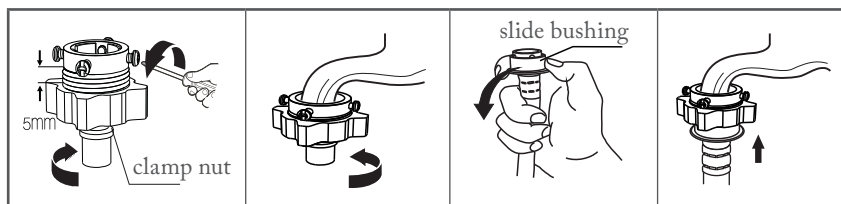

2.Connection between screw tap and inlet hose.

Raise

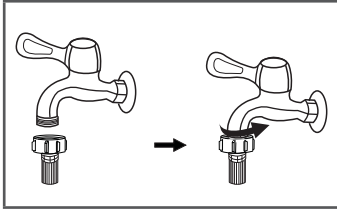

Tap with threads and inlet hose

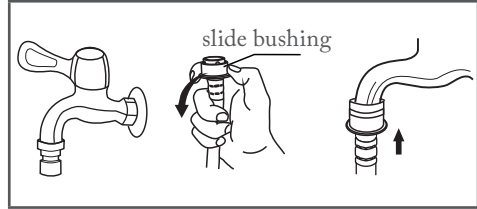

Special tap for washing machine

Connect the other end of inlet pipe to the inlet valve at the backside of product and fasten the pipe tightly clockwise.

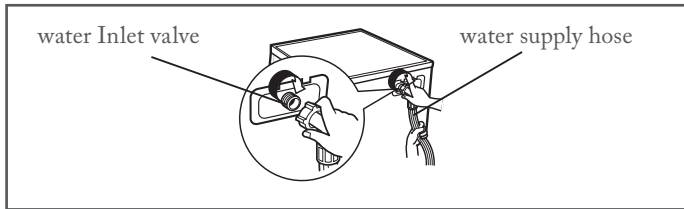

Drain Hose

⚠ Warning!

- Do not kink or protract the drain hose.
- Position drain hose properly, otherwise damage might result of water leakage.

There are two ways to place the end of drain hose:

1. Put it into the water trough.
2. Connect it to the branch drainpipe of the trough.

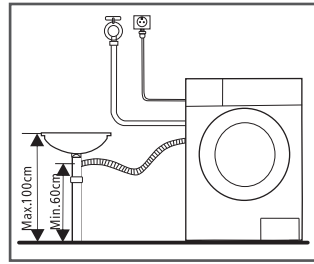
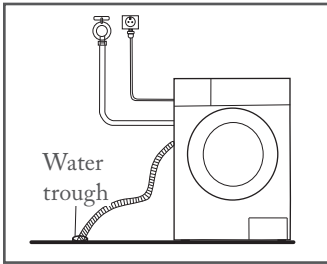

Note!

- If the machine has drain hose support, please install it like the following.

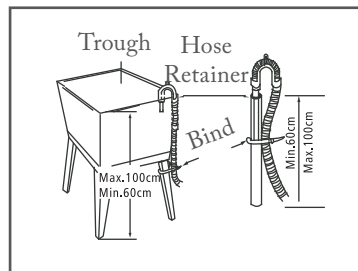
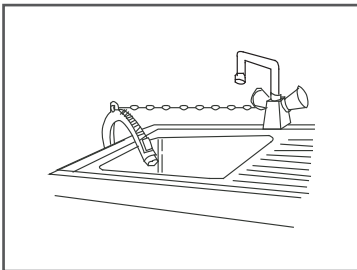

⚠ Warning!

- When installing drain hose, fix it properly with a rope.
- If drain hose is too long, do not force it into washing machine as it will cause abnormal noises.

OPERATIONS

Quick Start

⚠ Caution!

- Before washing, please make sure it's installed properly.
- Before washing at first time, the washing machine shall be operated in one round of the whole procedures without clothes in as follows.

1. Before Washing

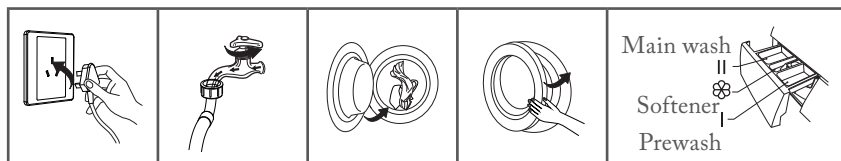

Plug in

Open
tap

Load

Close
door

Add detergent

Note!

- Detergent need to be added in «case I» after selecting pre-washing for machines with this function.

2. Washing

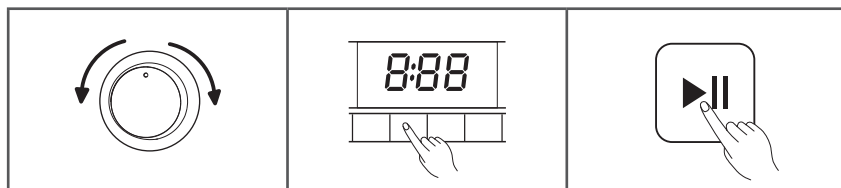

Select
Programme

Select function or
default

Start up

Note!

- If default is selected, step 2 can be skipped.

3. After Washing

«End» on display.

Before Each Washing

- The working condition of the washer should be (0-40) °C. If used under 0°C, the inlet valve and draining system may be damaged. If the machine is placed under condition of 0°C or less, then it should be transferred to normal ambient temperature to ensure the water supply hose and drain hose are not frozen before use.
- Please check the labels and the explanation of using detergent before wash. Use non-foaming or less-foaming detergent suitable for machine washing properly.

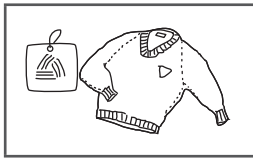

Check the label

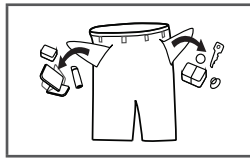

Take the items
out of the
pockets

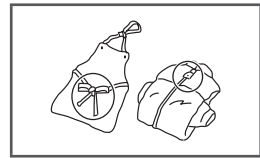

Knot the long
strips.zip or
button

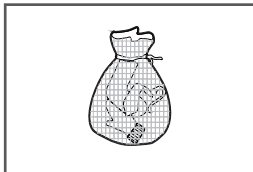

Put small
clothes into the
pillow slip

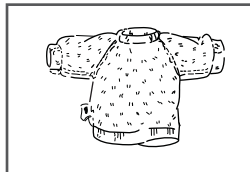

Turn easy-
pilling and
long-pile fabric
inside out

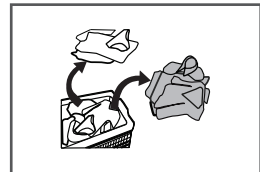

Separate
clothes with
different
textures

⚠ Warning!

- When washing a single piece of clothes, it may easily cause great eccentricity and give alarm due to great unbalance. Therefore, it is suggested to add one or two more clothes to be washed together so that draining can be done smoothly.
- Don't washing the clothes touching with kerosene, gasoline, alcohol and other flammable materials.

Detergent Dispenser

- I Pre-Wash detergent
- II Main Wash detergent
- ☼ Softener

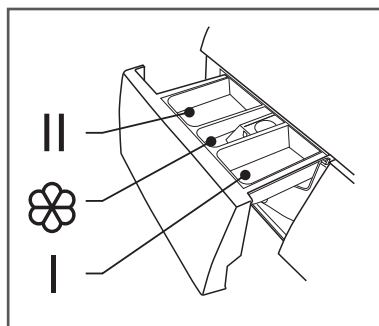

Pull out the dispenser

⚠ Caution!

- Detergent only need to be added in « case I » after selecting pre-washing for machines with this function.

Model: LF912RL21W

Programme	I	II	⊗	Programme	I	II	⊗
Cotton	○	●	○	Bulky/ Bedlinen	○	●	○
Synthetic	○	●	○	Baby Care	○	●	○
Mix	○	●	○	Wool		●	○
Jeans	○	●	○	Sport Wear	○	●	○
Spin Only				Rapid 45'	○	●	○
Rinse & Spin			○	Quick 15'		●	○
ECO 40-60		●	○	Intensive		●	○
20°C		●	○				
● Means must ○ Means optional							

Note!

- As for the agglomerated or ropy detergent or additive, before they are poured into the detergent box, it is suggested to use some water for dilution to prevent the inlet of detergent box from being blocked and overflowing while filling water.
- Please choose suitable type of detergent for the various washing temperature to get the best washing performance with less water and energy consumption.

Control Panel

Model: LF912RL21W

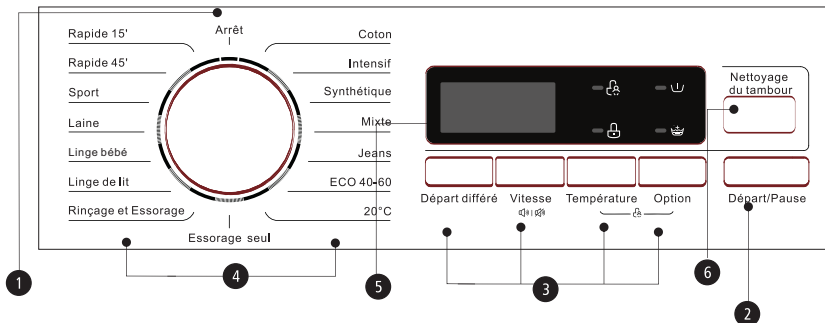

Note!

- The chart is for reference only, please refer to real product as standard.

① On/Off

Product is switched On/Off.

② Start/Pause

Press the button to start or pause the washing cycle.

③ Option

This allows you to select an additional function and will light when selected.

④ Programmes

Available according to the laundry type.

⑤ Display

The display shows the settings, estimated time remaining, options, and status messages for your washer. The display will remain on through the cycle.

⑥ Drum Clean

Specially set in this machine to clean the drum and tube.

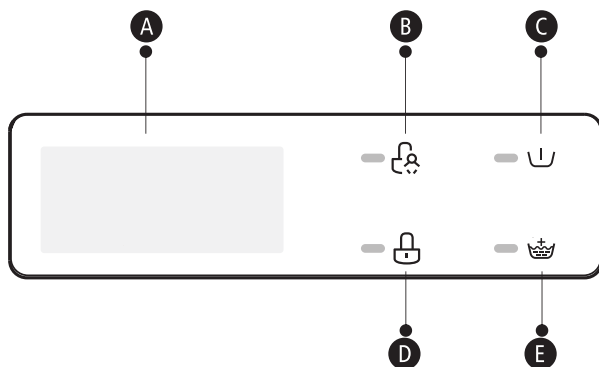

A Display

Wash Time

1:25

Speed

400

End

End

Delay Time

2h

Error

E30

Temp.

30

B Child Lock

C Pre-Wash

D Door Lock

E Extra Rinse

Option

Delay

Delay

Set the Delay function:

1. Select a programme;
2. Press the Delay button to choose the time of the delaying time is 0-24 H.);
3. Press [Start/Pause] to commence the delay operation



Choose the
Programme



Setting
time



Start

Cancel the Delay function:

Press the [Delay] button until the display be 0H. It should be pressed before starting the programme. If the programme already started, should switch off programme to reset a new one.

⚠ Caution!

- If there is any break in the power supply while the machine is operating, a special memory stores the selected programme and when the power is restarted, the program will continue.

Model: LF912RL21W

Programme	Option		
	Delay	Extra Rinse	Pre-Wash
Cotton	<input type="radio"/>	<input type="radio"/>	<input type="radio"/>
Synthetic	<input type="radio"/>	<input type="radio"/>	<input type="radio"/>
Mix	<input type="radio"/>	<input type="radio"/>	<input type="radio"/>
Jeans	<input type="radio"/>	<input type="radio"/>	<input type="radio"/>
Spin Only	<input type="radio"/>		
Rinse & Spin	<input type="radio"/>	<input type="radio"/>	
ECO 40-60	<input type="radio"/>		
20°C	<input type="radio"/>	<input type="radio"/>	
Bulky/Bedlinen	<input type="radio"/>	<input type="radio"/>	<input type="radio"/>
Baby Care	<input type="radio"/>	<input type="radio"/>	<input type="radio"/>
Wool	<input type="radio"/>	<input type="radio"/>	
Sport Wear	<input type="radio"/>	<input type="radio"/>	<input type="radio"/>
Rapid 45'	<input type="radio"/>	<input type="radio"/>	<input type="radio"/>

Programme	Option		
	Delay	Extra Rinse	Pre-Wash
Quick 15'	○		
Intensive	○		

○ Means optional (Some models have intelligent weighing function, please refer to the actual product)

Extra Rinse

The laundry will undergo extra rinse once after you select it.

Prewash

The Prewash function can get an extra wash before main wash. it is suitable for washing the dust rises to surface of the clothes; You need to put detergent into the Case (I) when select it.

Other Functions

Temp.

Temp.
Press the button to regulate the temperature (Cold, 20°C, 40°C, 60°C, 90°C)

Speed

Speed
Press the button to change the speed.
1200:0-400-600-800-1000-1200

LF912RL21W

Programme	Default Speed(rpm)	Programme	Default Speed(rpm)
	1200		1200
Cotton	800	Bulky/ Bedlinen	1000
Intensive	800	Baby Care	1000
Synthetic	800	Wool	600
Mix	1000	Sportwear	800
Jeans	1000	Rapid 45'	800
ECO 40-60	-	Quick 15'	800
20°C	1000	Rinse & Spin	1000
Spin Only	1000		



Child Lock

To avoid mis operation by children.



Choose the Programme



Start

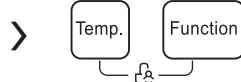

Press [Temp.] and [Function] 3 sec. till buzzer beep.

ⓘ Caution!

When child lock is activated and program starts, child lock indicator will switch on, and the CL and remaining time on the display are alternately displayed in 0.5s. Press the other buttons will make child lock indicator flash for 3s. when program is complete, CL and END alternate for 10s in 0.5s, then the child lock lights flash for 3s.

- only press and hold the two buttons can release child lock, even power off, switch off and program end
- The «Child Lock» will lock all buttons except Power button and Child Lock button
- please release child lock before selecting program and starting washing.



Mute the buzzer



Speed



Choose the Programme

Press the [Speed] button for 3sec., the buzzer is mute.

To act the buzzer function, press the button again for 3 seconds. The setting will be kept until the next reset.

ⓘ Caution!

- After Muting the buzzer function, the sounds will not be activated any more.



Drum Clean

After the machine runs to the set counting period (counting cycle is 25 times), Drum Clean lamp flashes at the end of the last program, reminding the user to run the program;

Release condition:

1. Press and hold the Drum Clean button for 3s, Drum cleaner indicator remind will be cancel and the washing cycles will be recount for another 25 cycles.
2. The counted cycles will be recounted when drum clean program is finished.

Programmes

Programmes are available according to the laundry type.

Programmes	
Cotton	Hard-wearing textiles, heat-resistant textiles made of cotton or linen.
Synthetic	Wash synthetic articles, for example: shirts, coats, blending. While washing the knitting textiles, detergent quantity shall be reduced due to its loose string construction and easily forming bubbles.
Baby Care	Washing the baby's clothes, it can make the baby's wear cleaner and make the rinse performance better to protect the baby skin.
Rapid 45'	Washing few and not very dirty clothes quickly.
Mix	Mixed load consisting of textiles made of cotton and synthetics.
Jeans	Specially for jeans.

Programmes	
20°C	Washing brightly colored clothes, it can protect the colors better.
Quick 15'	Extra short programme approx., suitable for lightly soiled washing as a small amount of laundry.
Wool	Hand or machine-washable wool or rich wool textiles. Especially gentle wash programme to prevent shrinkage, longer programme pauses (textiles rest in wash liquor).
Spin Only	Extra spin with selectable spin speed.
Rinse&Spin	Extra rinse with spin.
Sportwear	Washing the activewear.
Bulky/ Bedlinen	This program is specially designed for washing Bulky/ Bedlinen.
Intensive	To increase the washing effects, washing time is increased.
ECO 40-60	Default 40°C, not selectable or suitable for laundry washing at about 40°C-60°C.

Note!

- Reference to your product to select the programmes.

Washing Programmes Table

Model: LF912RL21W

Programme	Load(kg)	Temp.(°C)	Default Time
	9.0	Default	
Cotton	9.0	40	2:40
Intensive	9.0	40	3:48
Synthetic	4.5	40	2:20
Mix	9.0	40	1:20
Jeans	9.0	60	1:45
ECO 40-60	9.0	--	3:43
20°C	4.5	20	1:01
Spin Only	9.0	--	0:12
Rinse & Spin	9.0	--	0:20
Bulky/ Bedlinen	4.5	40	1:48
Baby Care	9.0	60	1:43
Wool	2.0	40	1:07
Sport Wear	4.5	20	0:45

Programme	Load(kg)	Temp.(°C)	Default Time
Rapid 45'	2.0	40	0:45
Quick 15'	2.0	Cold	0:15

- Concerning to EN 60456:2016 With (EU) No.1061/2010,
The EU energy efficiency class is: A+++
Energy test program: intensive; Speed: The highest speed; Temp.: 60/40°C; Other as the default. Half load for 9.0Kg machine:4.5Kg.
- Concerning to EN 60456:2016/prA2019 with (EU)2019/2014, (EUJ2019/2023,
The EU energy efficiency class is: E
Energy test program: ECO 40-60. Other as the default.
Half load for 9.0Kg machine:4.5Kg.
Quarter load for 9.0Kg machine:2.5Kg.

📌 Note!

- The parameters in this table are only for user's reference. The actual parameters maybe different with the parameters in above mentioned table.

MAINTENANCES

Cleaning And Care

⚠ Warning!

- Before your maintenance starts, please unplug the machine and close the tap.

Cleaning The Cabinet

Proper maintenance on the washing machine can extend its working life. The surface can be cleaned with diluted non-abrasive neutral detergents when necessary.

If there is any water overflow, use the wet cloth to wipe it off immediately.

No sharp items are allowed.

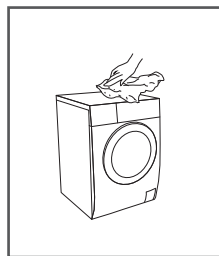

📌 Note!

- Formic acid and its diluted solvents or equivalent are forbidden, such as alcohol, solvents or chemical products.

Cleaning The Drum

The rusts left inside the drum by the metal articles shall be removed immediately with chlorine-free detergents.

Never use steel wool.

Note!

- Don't put laundry in the washing machine during the drum cleaning.

Cleaning The Door Seal And Glass

Wipe the glass and seal after each wash to remove lint and stains. If lint builds up it can cause leaks.

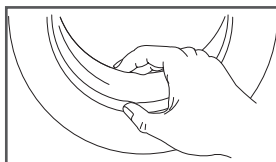

Remove any coins, buttons and other objects from the seal after each wash.

Cleaning The Inlet Filter

Note!

- Inlet filter must be cleaned if there is less water.

Washing the filter in the tap

1. Close the tap.
2. Remove the water supply hose from the tap.
3. Clean the filter.
4. Reconnect the water supply hose.

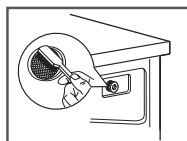
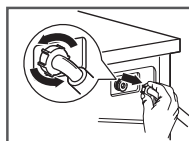
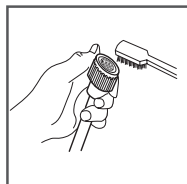
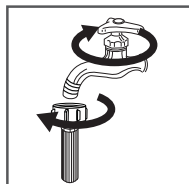

Washing the filter in washing machine:

1. Screw off the inlet pipe from the backside of the machine.
2. Pull out the filter with long nose pliers and reinstall it back after being washed.
3. Use the brush to clean the filter.
4. Reconnect the inlet pipe.

🔧 Note!

- If the brush is not clean, you can pull out the filter washed separately;
- Reconnect, turn on the tap.

Clean The Detergent Dispenser

1. Press down the arrow location on softener cover inside the dispenser drawer.
2. Lift the clip up and take out softener cover and wash all grooves with water.
3. Restore the softener cover and push the drawer into position.

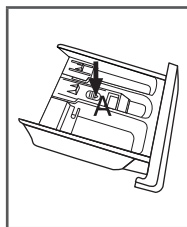

Pull out the dispenser drawer with press the A

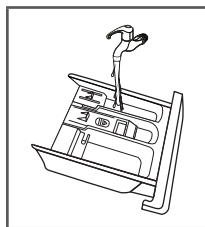

Clean the dispenser drawer underwater

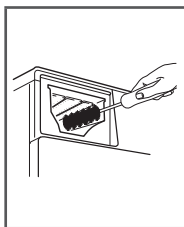

Clean inside the recess with an old toothbrush

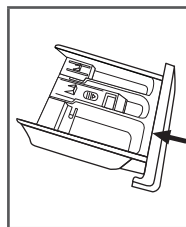

Insert the dispenser drawer

⚠ Note!

- Do not use alcohol, solvents or chemical products to clean the machine.

Cleaning The Drain Pump Filter

⚠ Warning!

- Be careful of the hot water!
- Allow detergent solution to cool down.
- Unplug the machine to avoid electrical shock before washing.
- Drain pump filter can filter the yarns and small foreign matters from the washing.
- Clean the filter periodically to ensure the normal operation of washing machine.

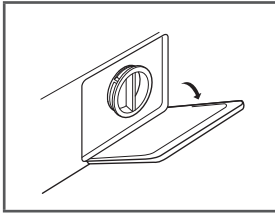

Open the lower cover cap

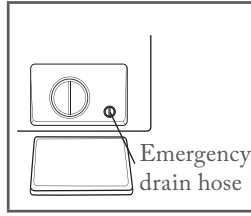

Rotate 90°
and pull out
the emergency
drain hose, and
take off the
hose cap

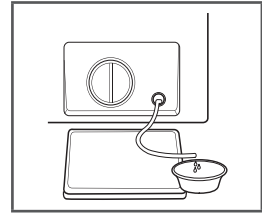

After water
runs out, reset
the drain hose

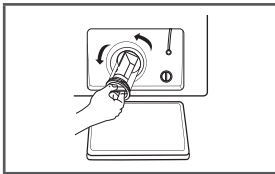

Open the filter
by turning to the
counterclockwise

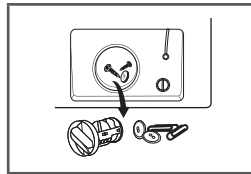

Remove
extraneous
matter

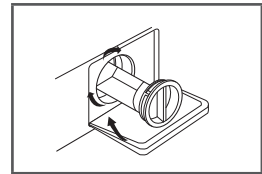

Close the lower
cover cap

ⓘ Caution!

- Make sure that valve cap and emergency drain hose are reinstalled properly, cap plates should be inserted aligning to hole plates otherwise water may leak.
- Some machines don't have emergency drain hose, so step 2 and step 3 can be skipped. Rotate lower cover cap directly to make water run into basin.
- When the appliance is in use and depending on the programme selected there can be hot water in the pump. Never remove the pump cover during a wash cycle, always wait until the appliance has finished the cycle, and is empty. When replacing the cover, ensure it is securely re-tightened.

Troubleshooting

The start of the appliance does not work, or it stops during operation. First try to find a solution to the problem, if not, contact the service centre.

Description	Reason	Solution
Washing machine cannot startup	Door is not closed properly	Restart after the door is closed Check if the clothes is stuck
Door can't be opened	Washer's safety protection design is working	Disconnect the power, restart the product
Water leakage	The connection between inlet pipe or outlet hose is not tight	Check and fasten water pipes Clean up outlet hose
Detergent residues in the box	Detergent is dampened or agglomerated	Clean and wipe the detergent box

Description	Reason	Solution
Indicator or display does not light	Disconnect the power PC board or harness has connection problem	Check if the power is shut down and the power plug is connected correctly
Abnormal noise		Check if the fixing (bolts) have been removed Check it's installed on a solid and level floor
E30	Door is not closed properly	Restart after the door is closed Check if the clothes is stuck

Description	Reason	Solution
E10	Water injecting problem while washing	Check if the water pressure is too low Straighten the water pipe Check if the inlet valve filter is blocked
E21	Overtime water draining	Check if the drain hose is blocked
E12	Water overflow	Restart the washer
EXX	Others	Please try again first, call up service line if there are still troubles

↳ Note!

- After the check, activate the appliance. If the problem occurs or the display shows other alarm codes again, contact the service.

Technical Specifications

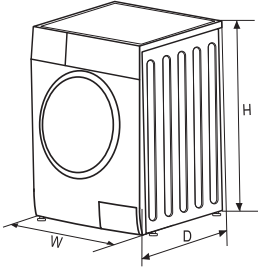
Power Supply	220-240V~, 50Hz (EU)			
MAX. Current	10A			
Standard Water Pressure	0.05MPa~ 1MPa			
Model	Washing Capacity	Dimension (W*D*Hmm)	Net Weight	Rated Power
LF912RL21W	9.0kg	595*565*850	71 kg	2000W

Product fiche

Product fiche concerning to Regulation (EU) No 1061/2010

Trademark	FAR
Model identifier	LF912RL21W
Rated capacity in kg of cotton laundry	9
Energy efficiency class on a scale from A+++ (most efficient) bis D (least efficient)	A+++
Energy consumption 218 kWh per year, based on 220 standard washing cycles for the standard cotton programmes at 60 °C and 40 °C at full and partial load, and the consumption of the low- power modes. Actual energy consumption will depend on how the appliance is used.	
Energy consumption of the standard 60°C cotton programme at full load	1,04kwh
Energy consumption of the standard 60°C cotton programme at partial load	0.95kwh

Energy consumption of the standard 40°C cotton programme at partial load	0.86kwh
Weighted power consumption of the off-mode	0.50W
Weighted power consumption of the left-on mode	1.00W
Water consumption 11800 litres per year, based on 220 standard washing cycles for the standard cotton programmes at 60 °C and 40 °C at full and partial load. Actual water consumption will depend on how the appliance is used.	
spin-drying efficiency class B on a scale from G (least efficient) to A (most efficient)	
maximum spin speed	1200
Remaining moisture content	53%
Intensive 60°C programme' and the ' Intensive 40°C programme' are the standard washing programmes to which the information in the label and the fiche relates, that these programmes are suitable to clean normally soiled cotton laundry and that they are the most efficient programmes in terms of combined energy and water consumption.	

Programme time of the standard 60°C cotton programme at full load	245min
Programme time of the standard 60°C cotton programme at half load	245min
Programme time of the standard 40°C cotton programme at half load	235min
duration time of left-on mode	-
Airborne acoustical noise emissions during washing phase	65dB
Airborne acoustical noise emissions during spinning phase	79dB
'built-in' washing machine	no

Energy test program: Intensive 60/40°C. Speed: the highest speed; Other as the default.

Product fiche concerning to Regulation (EU) No 2019-2014

Supplier's name or trademark: FAR					
Supplier's address (b): 80 boulevard du Mandinet, 77432 Marne la Vallée, Cedex 2					
Model identifier: FAR LF912RL21W					
General product parameters:					
Parameter	Value		Parameter	Value	
Rated capacity (a) (kg)	9.0		Dimensions in cm	Height	85
				Width	60
				Depth	57
EEIw (a)	91.0		Energy efficiency class (a)	E	
Washing efficiency index ft	1 -04		Rinsing effectiveness (g/kg) (a)	5.0	
Energy consumption in kWh per cycle, based on the eco 40-60 programme. Actual energy consumption will depend on how the appliance is used.	0.865		Water consumption in litre per cycle, based on the eco 40-60 programme. Actual water consumption will depend on how the appliance is used and on the hardness of the water.	50	
Maximum temperature inside the treated textile ft (°C)	Rated capacity	41	Remaining moisture content ft (%)	Rated capacity	53
	Half	32		Half	53
	Quarter	25		Quarter	53
Spin speed ft (rpm)	Rated capacity	1200	Spin-drying efficiency class ft	B	
	Half	1200			
	Quarter	1200			

Programme duration (a) (h: min)	Rated capacity	3: 48	Type	free-standing
	Half	2: 54		
	Quarter	2: 54		
Airborne acoustical noise emissions in the spinning phase (a) (dB(A) re 1 pW)	80		Airborne acoustical noise emission class (a) (spinning phase)	C
Off-mode (W)	0.50		Standby mode (W)	1.00
Delay start (W) (if applicable)	4.00		Networked standby (W) (if applicable)	N/A
Minimum duration of the guarantee offered by the supplier (b): 24 months				
This product has been designed to release silver ions during the washing cycle			NO	
Additional information:				
Weblink to the supplier's website, where the information in point 9 of Annex II to Commission Regulation (EU) 2019/2023 (1) (b) is found: www.conforama.fr				
(a) For the eco 40-60 programme. (b) Changes to these items shall not be considered relevant for the purposes of paragraph 4 of Article 4 of Regulation (EU) 2017/1369. (c) If the product database automatically generates the definitive content of this cell the supplier shall not enter these data.				

Note!

- Programme setting for testing in accordance with applicable standard En60456 for wash.
- Programme setting for testing in accordance with applicable standard En50229 for wash and dry.
- When using the test programmes, wash the specified load using the maximum spin speed.
- The actual parameters will depend on how the appliance is used, and maybe different with the parameters in above mentioned table.
- The noise emissions during washing/spinning for the standard washing cycle at full load.

DISPOSAL OF OLD ELECTRICAL APPLIANCES



This marking indicates that this product should not be disposed with other household wastes throughout the EU. To prevent possible harm to the environment or human health from uncontrolled waste disposal, recycle it responsibly to promote the sustainable reuse of material resources. To return your used device, please use the collection systems or contact the retailer where the product was purchased. They return and can take this product for environmentally safe recycling.

CE





CONFORAMA France SA
80 Boulevard du Mandinet
Lognes
77432 Marne la Vallée Cedex 2
FRANCE

