



La solution assistance

ERROR CODE



La solution assistance



Français

Page de

2

à

3



English

Page de

4

à

5



Español

Page de

6

à

7



Português

Page de

8

à

9



Polski

Page de

10

à

11



Magyar

Page de

12

à

13



Română

Page de

14

à

15



Deutsch

Page de

16

à

17

La solution assistance

CODES ERREUR

Sonde CONGELATEUR	Sonde DEGIVRAGE	Sonde AMBIANT	Défaut communication	Touche bloquée enfoncée
Total No Frost	Total No Frost	Total No Frost	Total No Frost	Total No Frost

Valeurs sondes de température

Tx()	R(KΩ)	Tx()	R(KΩ)	Tx ()	R(KΩ)	Tx()	R(KΩ)
-30	33.81	-18	16.90	2	5.873	8	4.372
-28	30.01	-16	15.12	3	5.587	10	3.972
-26	26.68	-10	10.920	4	5.315	15	3.141
-24	23.76	-5	8.392	5	5.060	20	2.501
-22	21.18	0	6.495	6	4.818	25	2.005
-20	18.90	1	6.175	7	4.589	30	1.617

Remplacement sonde de température FMF188348659 : Cette sonde est générique, vous pouvez être amené à couper les fils de la sonde défectueuse et à ressouder la nouveau lors de son remplacement si le connecteur est différent.

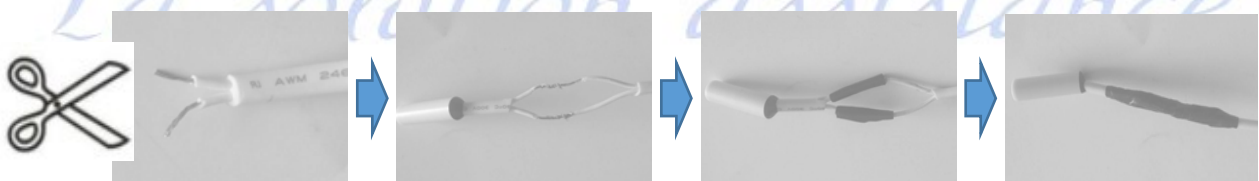

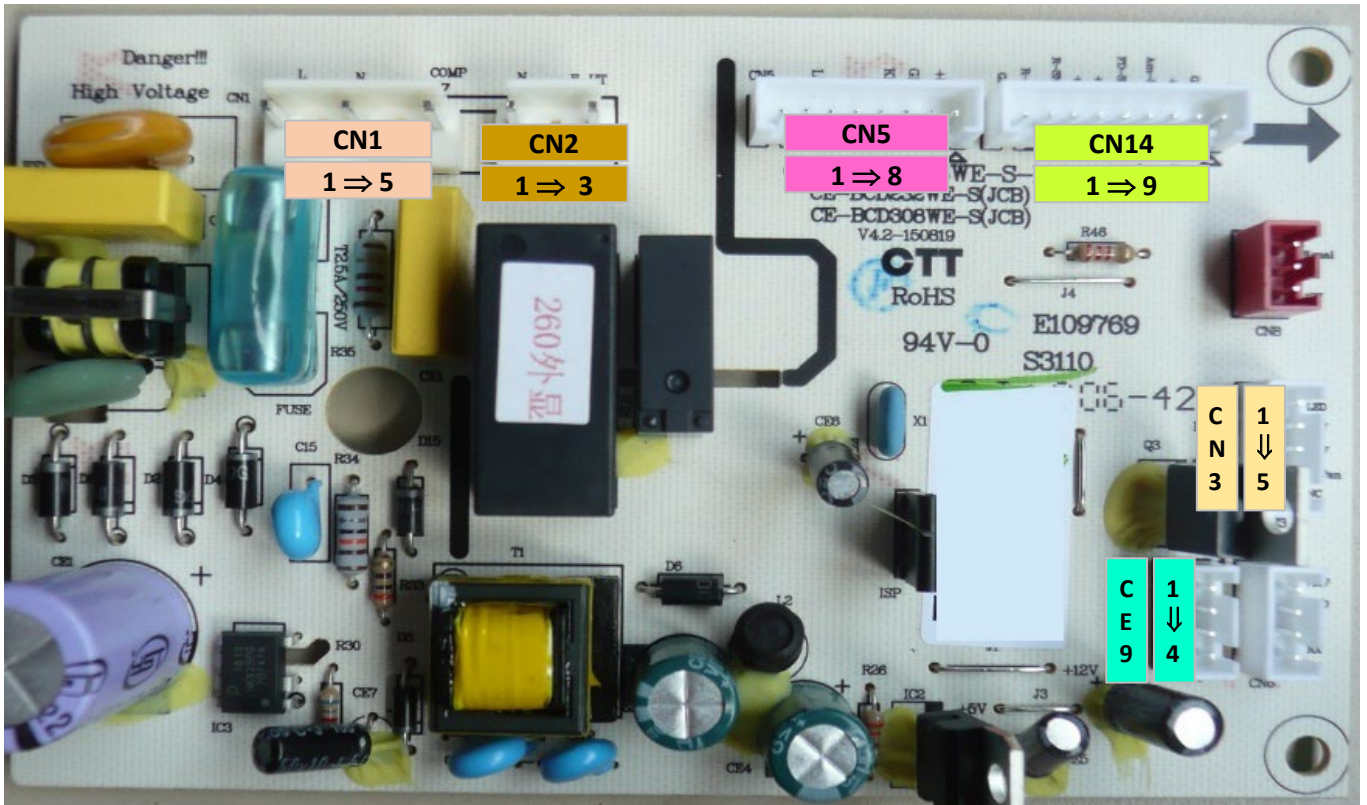

CN1	1	L	Phase	CE9	1	+12V	Afficheur
	2	-	-		2	Gnd	
	3	N	Neutre		3	RX	
	4	-	-		4	TX	
	5	Comp	Compresseur		CN2	1	
1	-	-	2	-		-	
2	-	-	3	F-Ht		Résistance dégivrage	
3	+12V	Ventilateur	CN14	1		GND	Interrupteur porte réfrigérateur
4	F Fan	-		2		R-SW	
5	-	-		3	RSnr	Sonde congélateur	
1	-	-		4	+5V	Sonde dégivrage	
2	-	-		5	+5V		
CN8	3	Led	Led	6	Fdsnr	Sonde ambiant	
	4	-	-	7	Asnr		
	5	-	-	8	+5V		
	6	KEY	-	9	GND	GND	
	7	Gnd	GND				
	8	+5V	+5V				

La solution assistance

ERROR CODES

FREEZER sensor	DEFROST probe	AMBIENT sensor	Communication fault	Stuck key pressed
Total No Frost	Total No Frost	Total No Frost	Total No Frost	Total No Frost

Temperature probe values

Tx()	R(KΩ)	Tx()	R(KΩ)	Tx ()	R(KΩ)	Tx()	R(KΩ)
-30	33.81	-18	16.90	2	5.873	8	4.372
-28	30.01	-16	15.12	3	5.587	10	3.972
-26	26.68	-10	10.920	4	5.315	15	3.141
-24	23.76	-5	8.392	5	5.060	20	2.501
-22	21.18	0	6.495	6	4.818	25	2.005
-20	18.90	1	6.175	7	4.589	30	1.617

Temperature sensor replacement **FMF188348659** : This probe is generic, you may have to cut the wires of the defective probe and resolder the new one when replacing it if the connector is different.

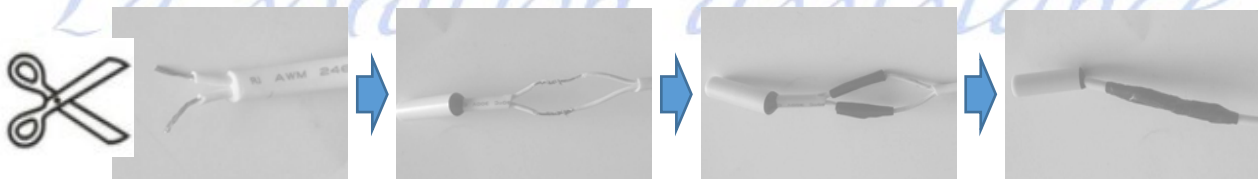

Panel wiring

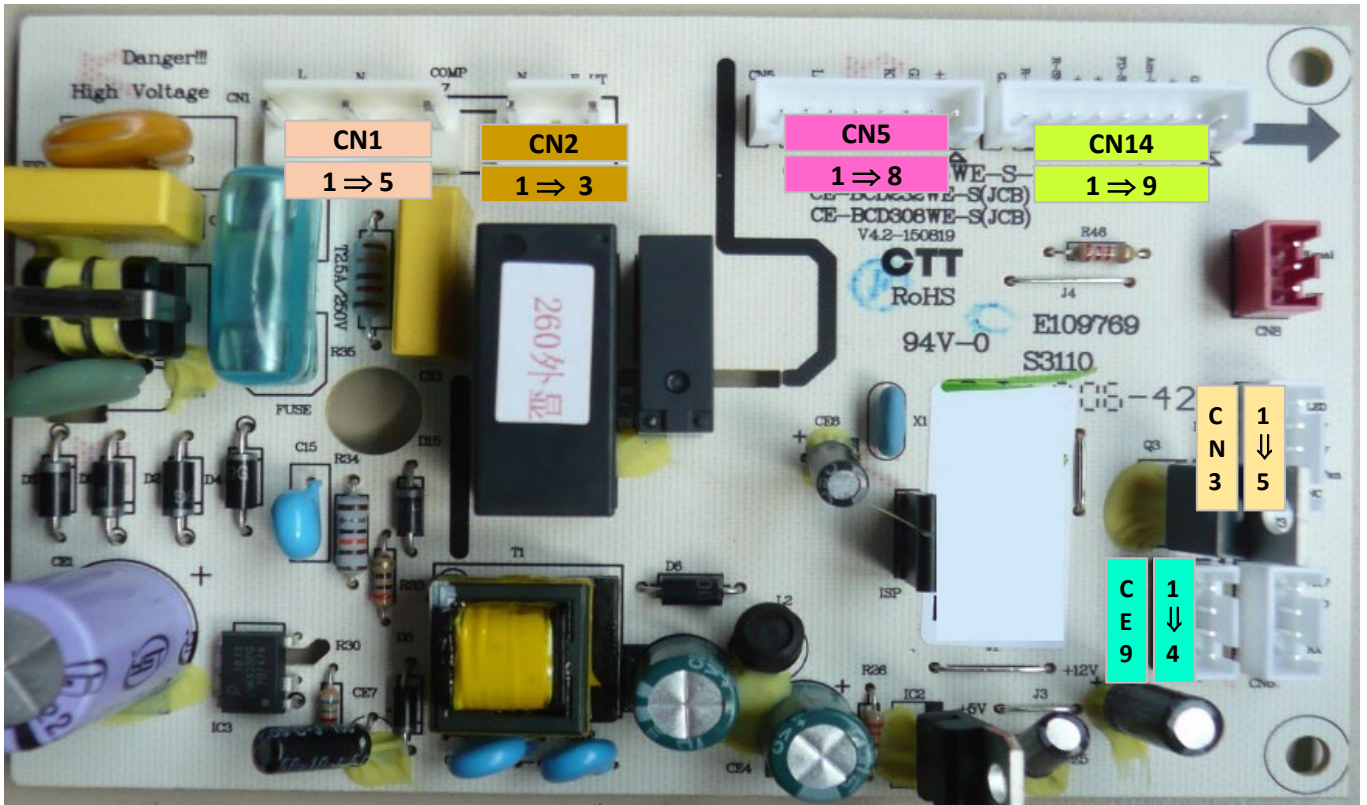

CN1	1	L	Phase	CE9	1	+12V	Display	
	2	-	-		2	Gnd		
	3	N	Neutral		3	RX		
	4	-	-		4	TX		
	5	Comp	Compressor		CN2	1		N
CN3	1	-	-	2		-	-	
	2	-	-	3		F-Ht	Defrost resistance	
	3	+12V	Fan	CN14		1	GND	refrigerator door switch
	4	F Fan				2	R-SW	
	5	-	-		3	RSnr	Freezer probe	
CN8	1	-	-		4	+5V	Defrost probe	
	2	-	-		5	+5V		
	3	Led	LEDs	6	Fdsnr	Ambient probe		
	4	-	-	7	Asnr			
	5	-	-	8	+5V			
	6	KEY	-	9	GND	GND		
	7	Gnd	GND					
	8	+5V	+5V					

La solution assistance

CÓDIGOS DE ERROR

Sonda CONGELADOR	sonda DESCONGELACIÓ	sensor AMBIENTE	Fallo de comunicación	Tecla atascada presionada

Valores de la sonda de temperatura

Tx()	R(KΩ)	Tx()	R(KΩ)	Tx ()	R(KΩ)	Tx()	R(KΩ)
-30	33.81	-18	16.90	2	5.873	8	4.372
-28	30.01	-16	15.12	3	5.587	10	3.972
-26	26.68	-10	10.920	4	5.315	15	3.141
-24	23.76	-5	8.392	5	5.060	20	2.501
-22	21.18	0	6.495	6	4.818	25	2.005
-20	18.90	1	6.175	7	4.589	30	1.617

Reemplazo del sensor de temperatura FMF188348659 : Esta sonda es genérica, es posible que tenga que cortar los cables de la sonda defectuosa y volver a soldar la nueva al reemplazarla si el conector es diferente.

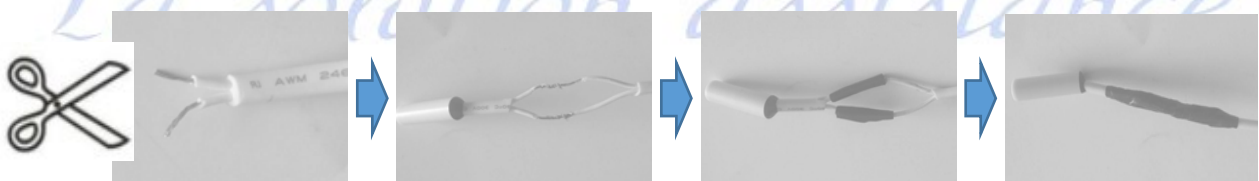

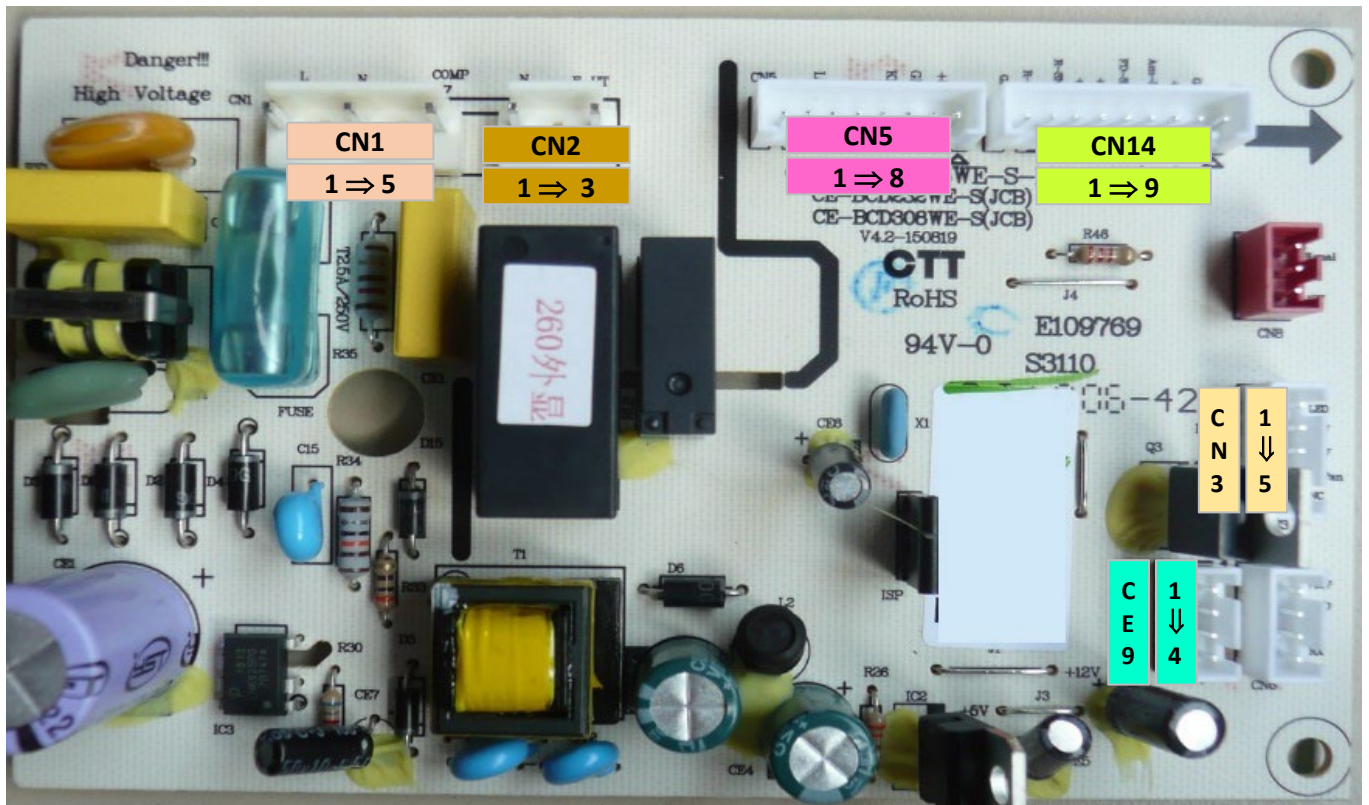

CN1	1	L	Fase	CE9	1	+12V	Monitor
	2	-	-		2	Gnd	
	3	N	neutral		3	RX	
	4	-	-		4	TX	
	5	Comp	Compresor		CN2	1	
CN3	1	-	-	2		-	-
	2	-	-	3		F-Ht	Resistencia al descongelamiento
	3	+12V	Admirador	1		GND	interruptor de la puerta del refrigerador
	4	F Fan	-	2		R-SW	-
	5	-	-	3	RSnr	Sonda de congelador	
CN8	1	-	-	CN14	4	+5V	Sonda de desescarche
	2	-	-		5	+5V	Sonda de desescarche
	3	Led	LED		6	Fdsnr	Sonda ambiental
	4	-	-		7	Asnr	Sonda ambiental
	5	-	-		8	+5V	-
	6	KEY	-		9	GND	TIERRA
	7	Gnd	TIERRA				
	8	+5V	+5V				

La solution assistance

CÓDIGOS DE ERRO

Sensor do CONGELADOR	Sonda de DESCONGELAÇÃO	Sensor AMBIENTE	Falha de comunicação	Tecla travada pressionada
Total No Frost	Total No Frost	Total No Frost	Total No Frost	Total No Frost

Valores da sonda de temperatura

Tx()	R(KΩ)	Tx()	R(KΩ)	Tx ()	R(KΩ)	Tx()	R(KΩ)
-30	33,81	-18	16,90	2	5.873	8	4.372
-28	30.01	-16	15.12	3	5.587	10	3.972
-26	26,68	-10	10.920	4	5.315	15	3.141
-24	23,76	-5	8.392	5	5.060	20	2.501
-22	21.18	0	6.495	6	4.818	25	2.005
-20	18.90	1	6.175	7	4.589	30	1.617

Substituição do sensor de temperatura **FMF188348659** : Esta sonda é genérica, você pode ter que cortar os fios da sonda defeituosa e ressoldar a nova ao substituí-la se o conector for diferente.

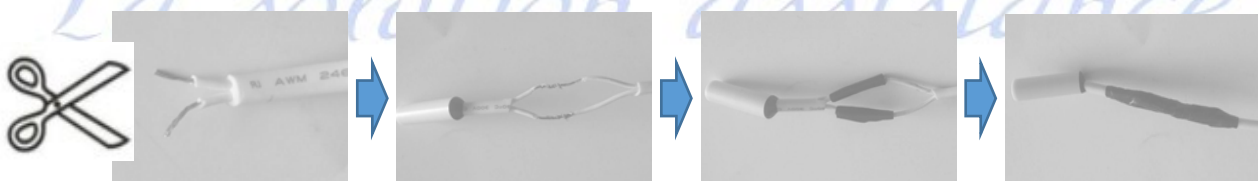

Fiação do painel

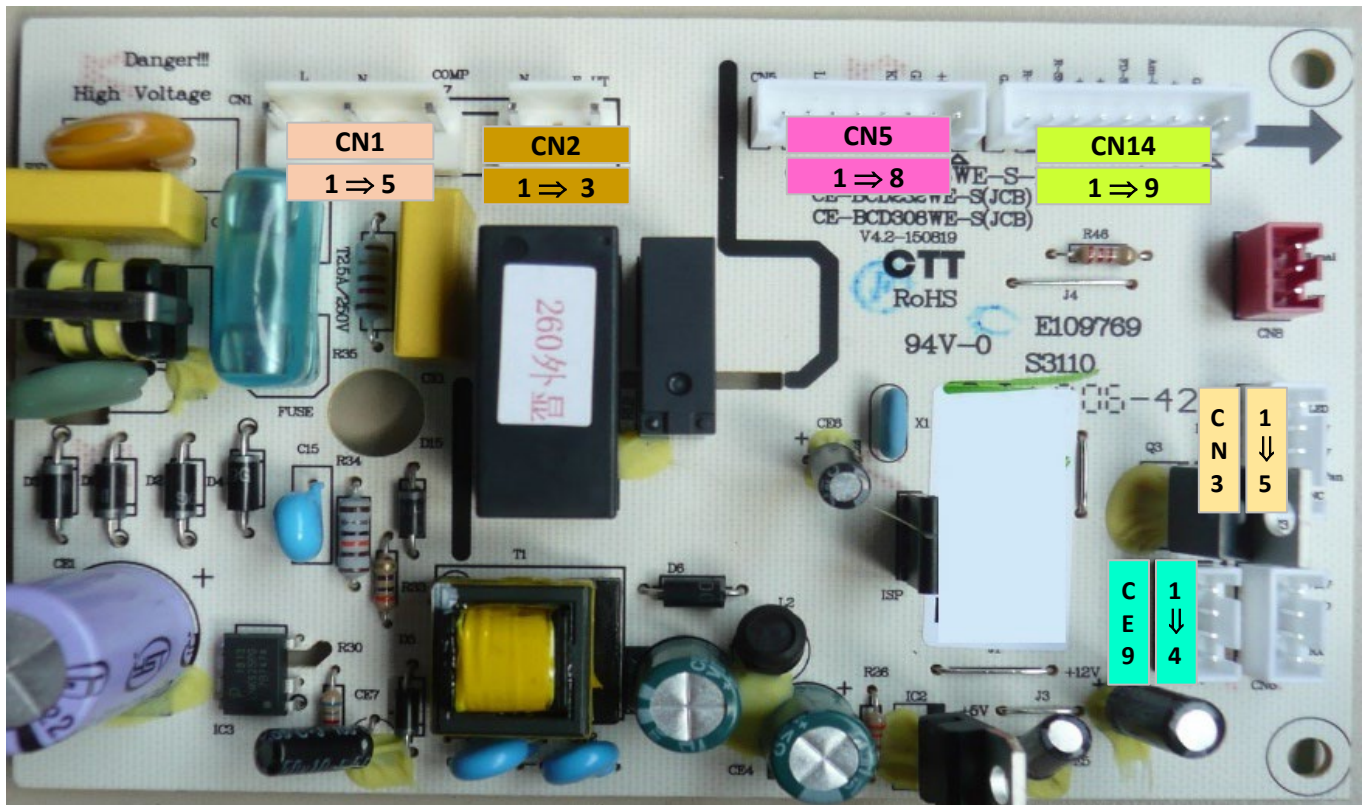

CN1	1	L	Estágio	CE9	1	+12V	Exibição	
	2	-	-		2	Gnd		
	3	N	Neutro		3	RX		
	4	-	-		4	TX		
	5	Comp	Compressor		CN2	1		N
CN3	1	-	-	2		-	-	
	2	-	-	3		F-Ht	Resistência ao degelo	
	3	+12V	Fã	CN14		1	GND	interruptor da porta da geladeira
	4	F Fan	-			2	R-SW	
	5	-	-		3	RSnr	Sonda do congelador	
CN8	1	-	-		4	+5V	Sonda de descongelamento	
	2	-	-		5	+5V		
	3	Led	LEDs	6	Fdsnr	Sonda ambiente		
	4	-	-	7	Asnr			
	5	-	-	8	+5V			
	6	KEY	-	9	GND	GND		
	7	Gnd	GND					
	8	+5V	+5V					

La solution assistance

KODY BŁĘDÓW

Czujnik ZAMRAŻARKI	Sonda ROZMRAŻANIA	Czujnik OTOCZENIA	Błąd komunikacji	Zablokowany klawisz wciśnięty
Total No Frost	Total No Frost	Total No Frost	Total No Frost	Total No Frost

Wartości sondy temperatury

Tx()	R(KΩ)	Tx()	R(KΩ)	Tx ()	R(KΩ)	Tx()	R(KΩ)
-30	33,81	-18	16.90	2	5,873	8	4.372
-28	30.01	-16	15.12	3	5,587	10	3,972
-26	26,68	-10	10.920	4	5.315	15	3.141
-24	23,76	-5	8.392	5	5.060	20	2,501
-22	21.18	0	6,495	6	4,818	25	2.005
-20	18,90	1	6.175	7	4,589	30	1,617

Wymiana czujnika temperatury FMF188348659 : Ta sonda jest ogólna, może być konieczne przecięcie przewodów uszkodzonej sondy i odsprzedanie nowej podczas wymiany, jeśli złącze jest inne.

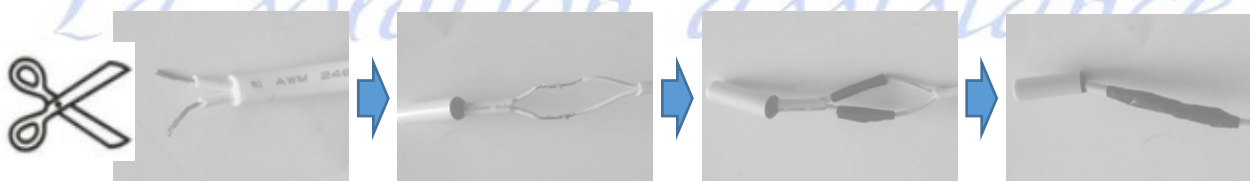

Okablowanie panelu

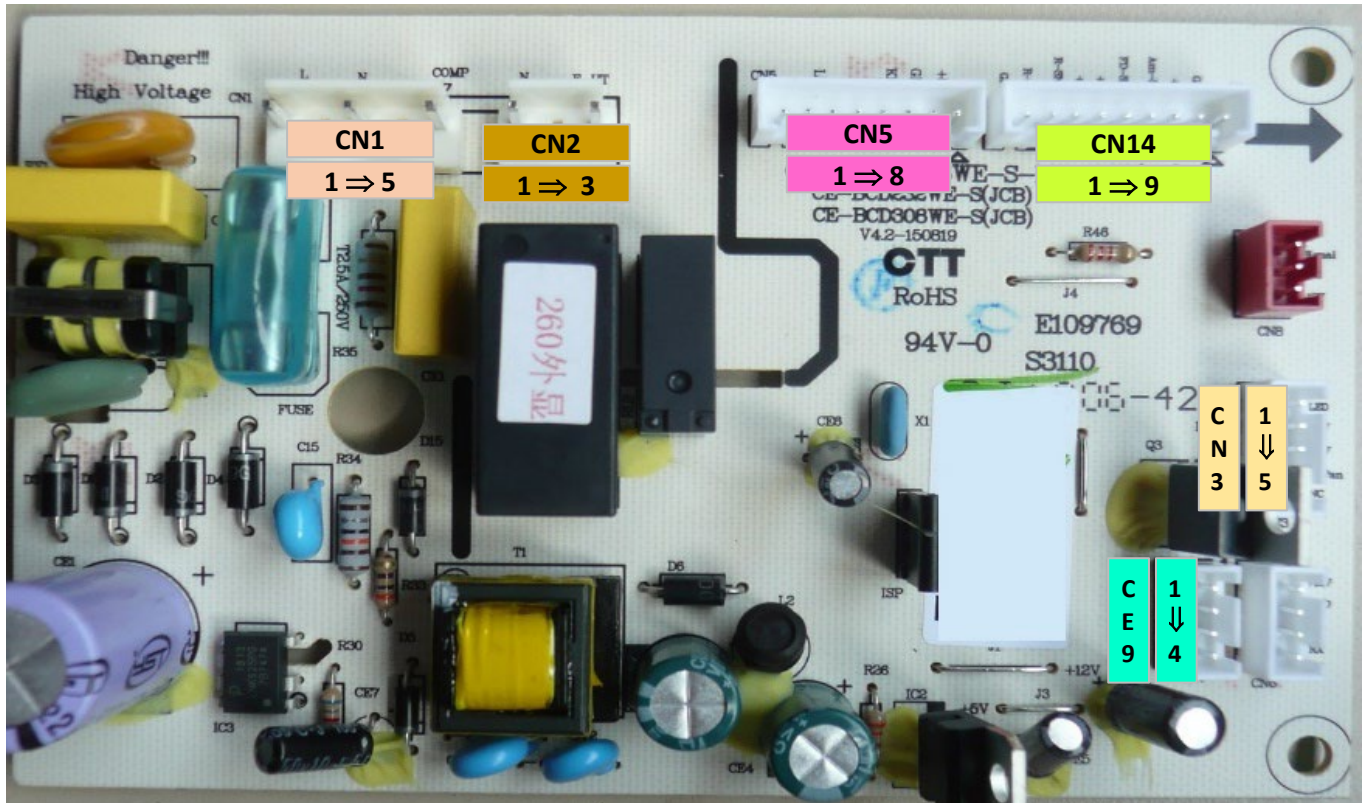

CN1	1	L	Faza	CE9	1	+12V	Wyświetlacz
	2	-	-		2	Gnd	
	3	N	Neutralny		3	RX	
	4	-	-		4	TX	
	5	Comp	Kompresor				
CN3	1	-	-	CN2	1	N	Neutralny
	2	-	-		2	-	-
	3	+12V	Miłośnik		3	F-Ht	Odporność na odszranianie
	4	F Fan	-		1	GND	przełącznik drzwi lodówki
	5	-	-		2	R-SW	Sonda zamrażarki
CN8	1	-	-	CN14	3	RSnr	Sonda odszraniania
	2	-	-		4	+5V	Sonda otoczenia
	3	Led	diody LED		5	+5V	GND
	4	-	-		6	Fdsnr	
	5	-	-		7	Asnr	
	6	KEY	-		8	+5V	
	7	Gnd	GND		9	GND	
	8	+5V	+5V				

La solution assistance

HIBAKÓDOK

FREEZER érzékelő	LEOLVASZTÁS szonda	ABIENT érzékelő	Kommunikációs hiba	Elakadt gomb lenyomva
Total No Frost	Total No Frost	Total No Frost	Total No Frost	Total No Frost

Hőmérséklet-szonda értékek

Tx()	R(KΩ)	Tx()	R(KΩ)	Tx ()	R(KΩ)	Tx()	R(KΩ)
-30	33.81	-18	16.90	2	5.873	8	4.372
-28	30.01	-16	15.12	3	5.587	10	3.972
-26	26.68	-10	10.920	4	5.315	15	3.141
-24	23.76	-5	8.392	5	5.060	20	2.501
-22	21.18	0	6.495	6	4.818	25	2.005
-20	18.90	1	6.175	7	4.589	30	1.617

Hőmérséklet érzékelő csere **FMF188348659** : Ez a szonda általános, előfordulhat, hogy el kell vágni a hibás szonda vezetőkeit, és cserekor újra kell forrasztani az újat, ha más a csatlakozó.

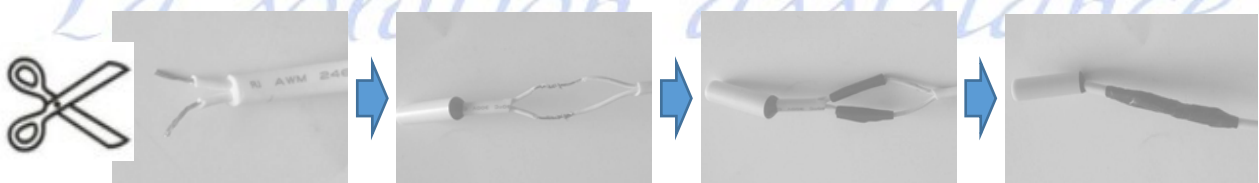

Panel huzalozás

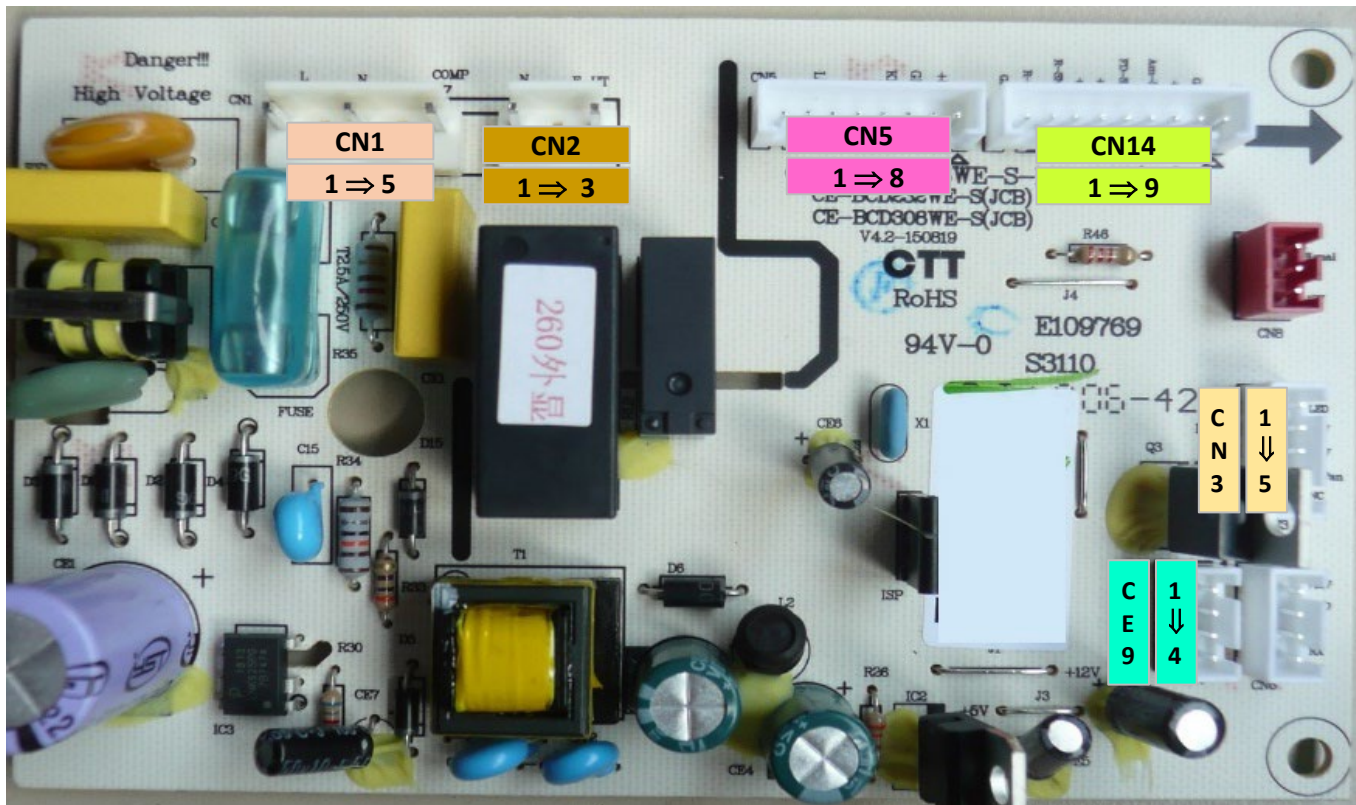

CN1	1	L	Fázis	CE9	1	+12V	Kijelző		
	2	-	-		2	Gnd			
	3	N	Semleges		3	RX			
	4	-	-		4	TX			
	5	Comp	Kompresszor		CN2	1		N	Semleges
CN3	1	-	-	2		-	-		
	2	-	-	3		F-Ht	Leolvasztási ellenállás		
	3	+12V	Ventilátor	1		GND	hűtőajtó kapcsoló		
	4	F Fan		2		R-SW			
	5	-		-	3	RSnr		Fagyasztó szonda	
CN8	1	-		-	CN14	4		+5V	Leolvasztó szonda
	2	-		-		5		+5V	
	3	Led	LED-ek	6		Fdsnr	Környezeti szonda		
	4	-	-	7		Asnr			
	5	-	-	8		+5V			
	6	KEY	-	9		GND	GND		
	7	Gnd	GND						
	8	+5V	+5V						

La solution assistance

CODURI DE EROARE

Senzor congelator	Sonda DEZGHEZARE	Senzor de AMBIENT	Eroare de comunicare	Tasta blocată apăsată
Total No Frost	Total No Frost	Total No Frost	Total No Frost	Total No Frost

Valorile sondei de temperatură

Tx()	R(KΩ)	Tx()	R(KΩ)	Tx ()	R(KΩ)	Tx()	R(KΩ)
-30	33,81	-18	16.90	2	5.873	8	4.372
-28	30.01	-16	15.12	3	5.587	10	3.972
-26	26.68	-10	10.920	4	5.315	15	3.141
-24	23.76	-5	8.392	5	5.060	20	2.501
-22	21.18	0	6.495	6	4.818	25	2.005
-20	18.90	1	6.175	7	4.589	30	1.617

Înlocuirea senzorului de temperatură **FMF188348659** : Această sondă este generică, poate fi necesar să tăiați firele sondei defecte și să o resedați pe cea nouă atunci când o înlocuiți dacă conectorul este diferit.

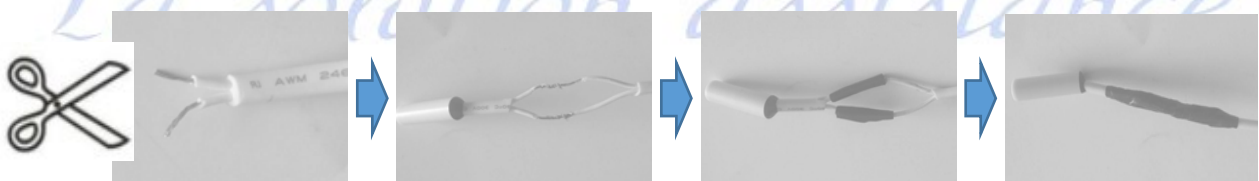

Cablajul panoului

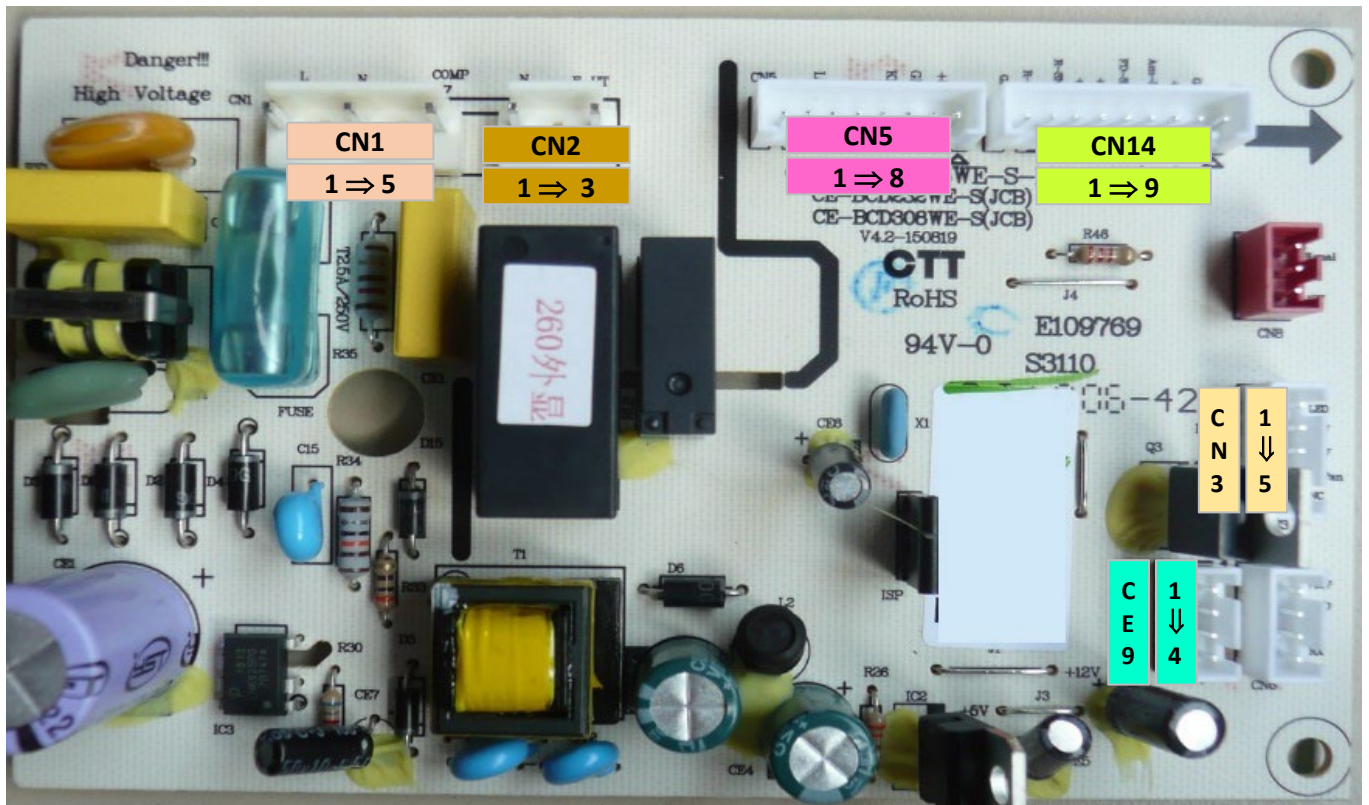

CN1	1	L	Fază	CE9	1	+12V	Afișa
	2	-	-		2	Gnd	
	3	N	Neutru		3	RX	
	4	-	-		4	TX	
	5	Comp	Compresor	CN2	1	N	Neutru
1	-	-	2		-	-	
2	-	-	3		F-Ht	Rezistenta la dezghetare	
3	+12V	Ventilator	CN14		1	GND	întreupător ușă frigiderului
4	F Fan	-			2	R-SW	Sonda congelatorului
5	-	-		3	RSnr	Sondă de dezghețare	
1	-	-		4	+5V	Sondă ambientală	
CN8	2	-	-	5	+5V	GND	
	3	Led	LED-uri	6	Fdsnr		
	4	-	-	7	Asnr		
	5	-	-	8	+5V		
	6	KEY	-	9	GND		
	7	Gnd	GND				
	8	+5V	+5V				

La solution assistance

FEHLERCODES

FREEZER-Sensor	DEFROST-Sonde	Umgebungssensor	Kommunikationsfehler	Festsitzende Taste gedrückt
Total No Frost	Total No Frost	Total No Frost	Total No Frost	Total No Frost

Temperaturfühlerwerte

Tx()	R(KΩ)	Tx()	R(KΩ)	Tx ()	R(KΩ)	Tx()	R(KΩ)
-30	33.81	-18	16.90	2	5.873	8	4.372
-28	30.01	-16	15.12	3	5.587	10	3.972
-26	26.68	-10	10.920	4	5.315	15	3.141
-24	23.76	-5	8.392	5	5.060	20	2.501
-22	21.18	0	6.495	6	4.818	25	2.005
-20	18.90	1	6.175	7	4.589	30	1.617

Austausch des Temperatursensors FMF188348659 : Diese Sonde ist generisch, Sie müssen möglicherweise die Drähte der defekten Sonde abschneiden und die neue Sonde neu anlöten, wenn Sie sie ersetzen, wenn der Stecker anders ist.

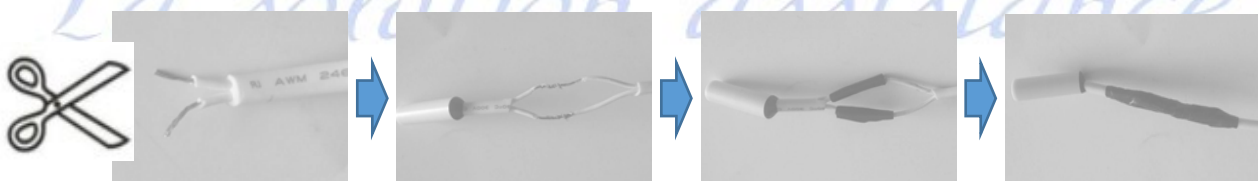

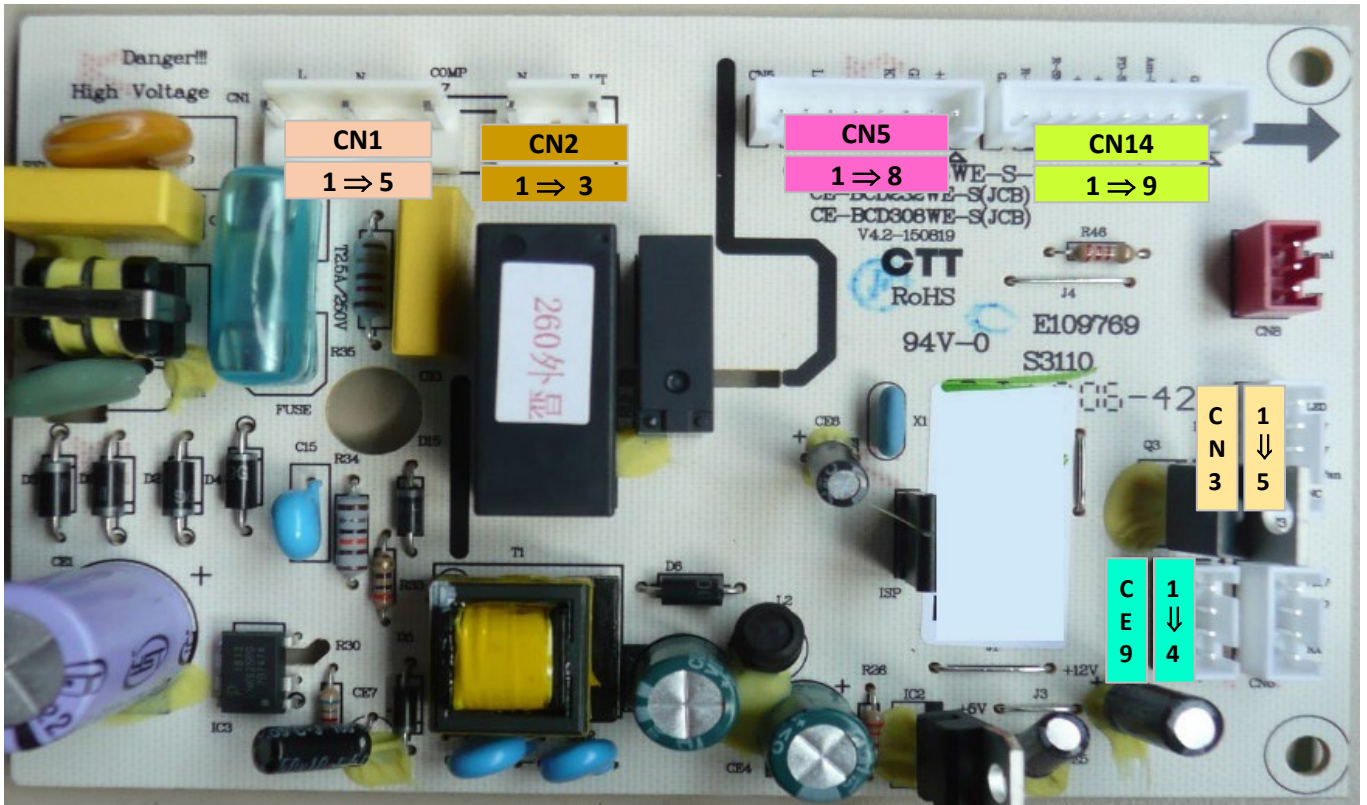

CN1	1	L	Phase	CE9	1	+12V	Anzeige	
	2	-	-		2	Gnd		
	3	N	Neutral		3	RX		
	4	-	-		4	TX		
	5	Comp	Kompressor		CN2	1		N
CN3	1	-	-	2		-	-	
	2	-	-	3		F-Ht	Abtaubeständigkeit	
	3	+12V	Fan	CN14		1	GND	Türschalter für Kühlschrank
	4	F Fan				2	R-SW	Gefriersonde
	5	-	-		3	RSnr		
CN8	1	-	-		4	+5V	Abtausonde	
	2	-	-		5	+5V		
	3	Led	Leuchtdioden	6	Fdsnr	Umgebungssonde		
	4	-	-	7	Asnr			
	5	-	-	8	+5V	Masse		
	6	KEY	-	9	GND			
	7	Gnd	Masse					
		8	+5V	+5V				

La solution assistance